

<b>Sale Model :</b>	FPA-36
<b>Power Supply :</b>	208_230V_1Ph, 60HZ

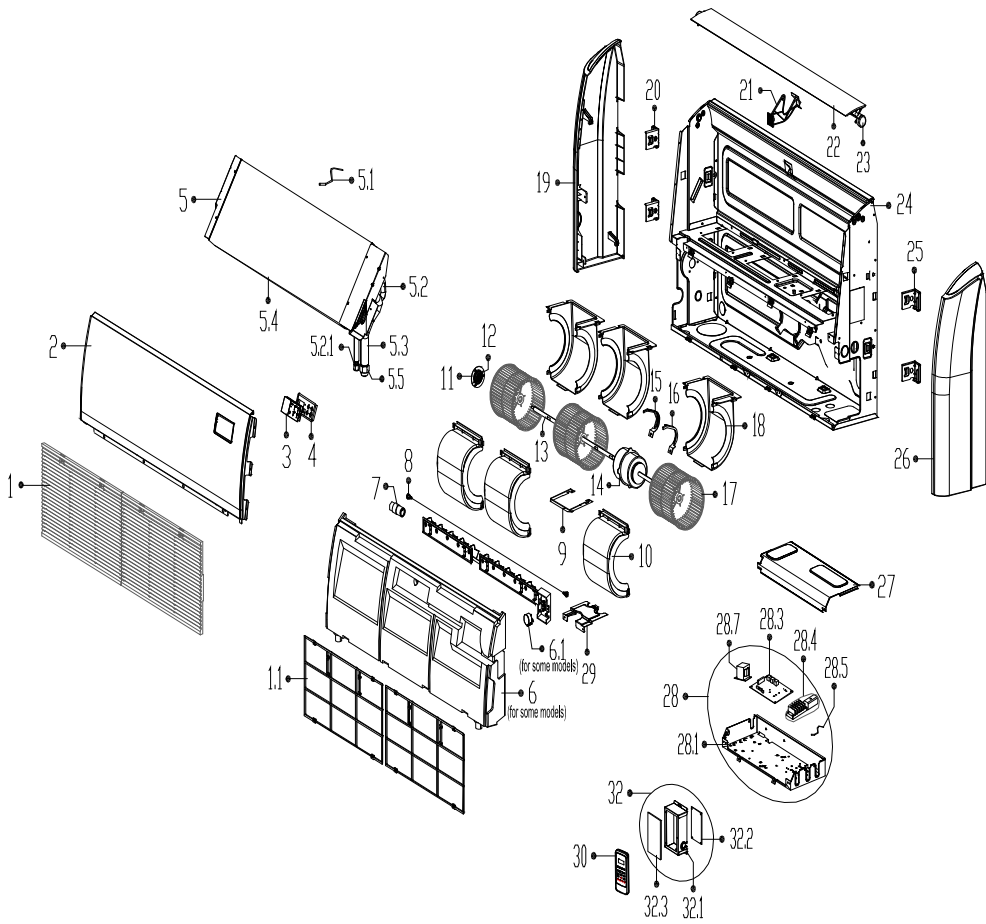

No.	Part Name	Quantity	PART #
1	Air inlet grille assembly I	2	201144790015
1.1	Air filter	1	201144790024
2	Top cover assembly	1	201244490047
3	Display board assembly	1	201344790040
4	Display installation box	1	201144790016
5	Evaporator assembly	1	2015444A0063
5.1	Pipe temperature sensor assembly	1	202301300111
5.1	Pipe temperature sensor assembly	1	202301300804
5.2	Input pipe assembly	1	201644690252
5.2.1	Copper nut	1	201600320001
5.3	Output pipe assembly	1	201644490324
5.4	Evaporator	1	2015446A0056
5.5	Copper nut	1	201600320003
7	Coupling	1	202970790001
8	Insulated axis	2	201132590888
9	Fan motor fixing board	1	201252490002
10	Volute shell (above)	3	201144790030

11	Bearing fixing board	1	201287000011
12	Bearing base	1	202732400001
13	Connecting shaft	1	202501180104
14	Asynchronous motor	1	202400300512
15	Fan motor axes clamp (right)	1	201280200006
16	Fan motor axes clamp (left)	1	201280200005
17	Plastic fan	3	201100100870
18	Volute shell (below)	3	201144790029
19	Right cover	1	201144790017
20	Right hook	2	201244790033
21	Supporter of louver	1	201144790018
22	Louver	1	201144490040
23	Louver motor	1	202400200162
24	Chassis assembly	1	12222700000226
25	Left hook	2	201244790034
26	Left cover	1	201144790019
27	Cover of electronic control box	1	201244490055
28	Electronic control box assembly	1	203344490083
28.1	Electronic control box	1	201244790050
28.3	Main control board assembly	1	201344490074
28.4	Wire joint	1	202301400488
28.4	Wire joint	1	202301450119
28.5	Ambient temperature sensor assembly	1	202301310072
29	Pipe clamp board	1	201244790047
30	Remote controller	1	2033550A9167
32	Electronic control box assembly	1	203319900796
32.1	Electronic control box	1	201270590340
32.2	Inverter control board assembly	1	201319903060
32.3	Radiator	1	202301900138