

Market model:

MAH42-410

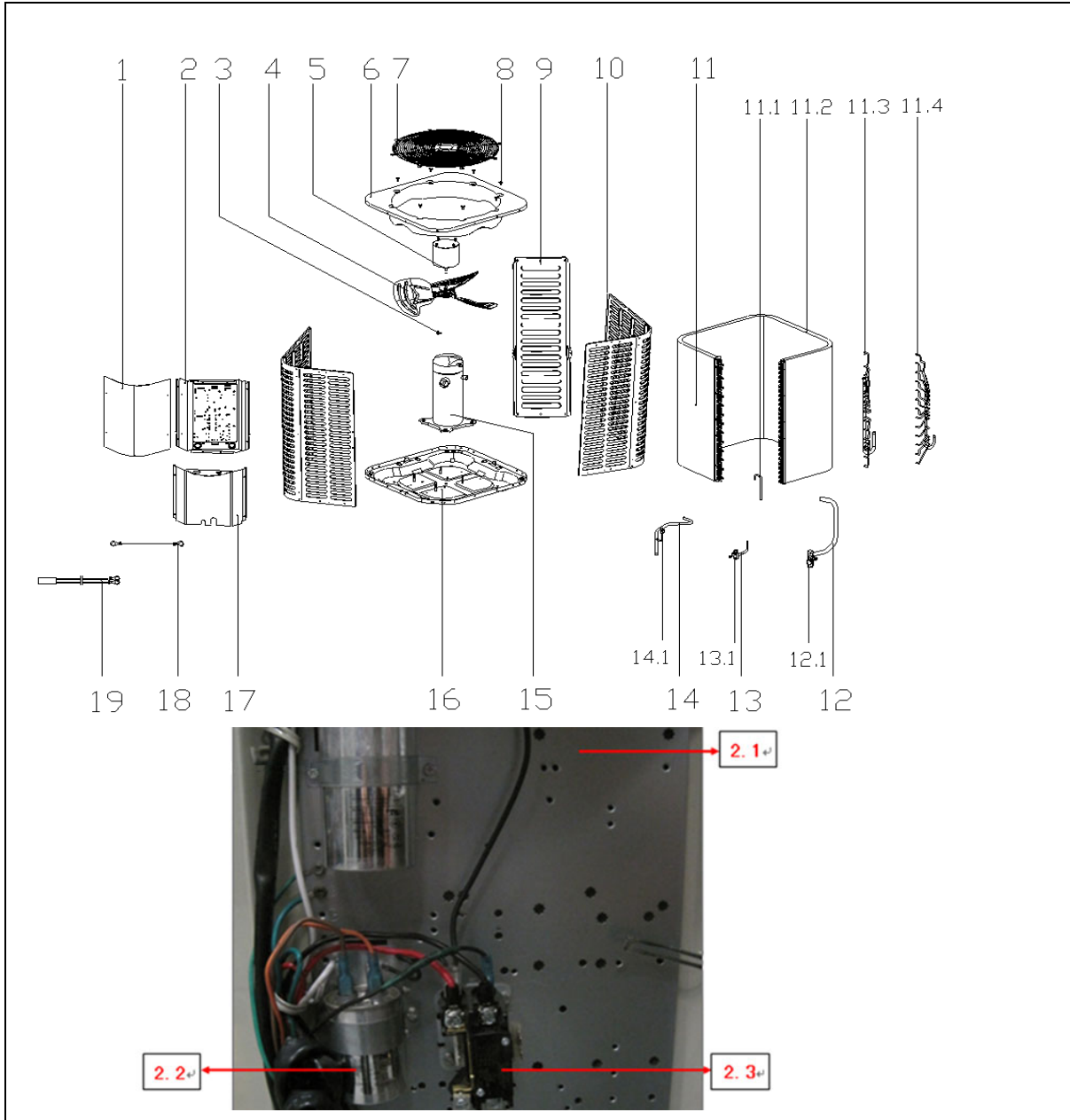

No.	Part Name	Quantity	BOM Code	Price	Remark
1	Top air outlet cover	1.0	12223100000223		
2	E-part box assembly	1.0	17223000004757		
2.1	Installation board assembly	1.0	12223000010791		
2.2	Capacitor	1.0	17400103000150		
2.3	Capacitor	1.0	17400103000151		
2.4	AC contactor 24V	1.0	11203502000032		
3	Nut	1.0	11301512000143		
4	Axial fan	1.0	12200104000032		
5	Motor	1.0	11002012000741		
6	Top cover assembly	1.0	12223000001097		
7	Grille	1.0	12923000000028		
8	Stainless steel bolts	8.0	11301002000001		
9	Supporting board	1.0	12223100000243		
10	Side panel assembly	2.0	12223000005909		
11	Condenser assembly	1.0	15823000000265		
11.1	Evaporator connection pipe assembly	1.0	15123000000741		
11.2	Condenser	1.0	15823000000266		
11.3	Input pipe assembly I of condenser	1.0	15123000004421		
11.4	Output pipe assembly I of condenser	1.0	15123000000742		
12	Low pressure valve assembly	1.0	15423000001323		
12.1	Block valve	1.0	15500206000026		
13	High pressure valve assembly	1.0	15423000003178		
13.1	Block valve	1.0	15500206000018		
14	Discharge pipe assembly	1.0	15423000001217		
14.1	Pressure switch	1.0	17400516000032		
15	Compressor	1.0	11102010000412		
16	Base assembly	1.0	12223000005895		
17	Clapboard assembly	1.0	12223100000240		
18	Green ground line	1.0	17401110000020		
19	Compressor wire joint assembly	1.0	17401203001230		