

Model: LUC36
 Power supply: 208/230V_1Ph_60HZ

ComfortStar®

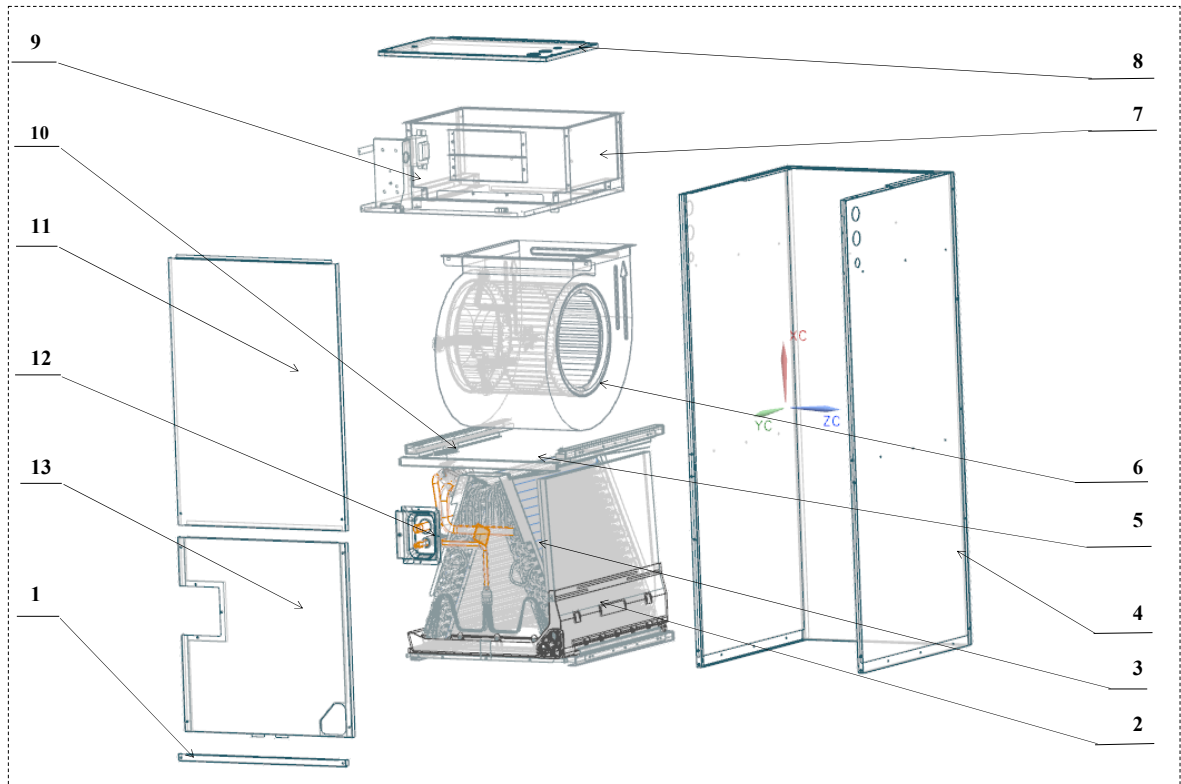
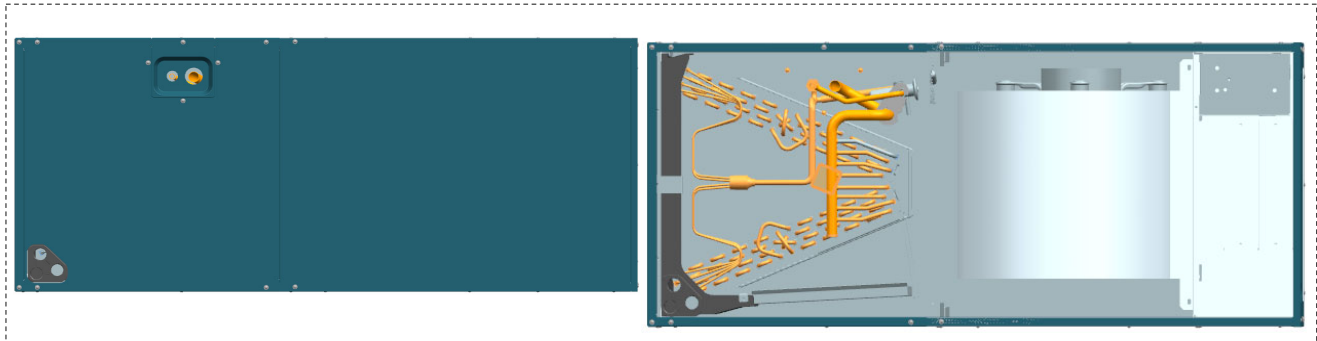

No.	Part Name	Quantity	Sale code	BOM code
1	Filter Cover plate	1		801234590089
2	Water pan components	1		801232590060
2.1	Water pan# 1	1		801134590002
2.2	Water pan# 2	1		800734590102
2.3	Water pan fixed block	1		801234590091
2.4	Water pan brace	2		801234190193
3	Evaporator components	1		801533590047
3.1	Air header Assembly	1		801633590039
3.2	Diverter Assembly	1		801633590040
3.3	Evaporator	2		801533590038
3.4	Evaporator Baffle	1		801239390040
3.5	Evaporator Baffle	1		801233590156
3.6	Evaporator Water Baffle #1	2		801234590095
3.7	Evaporator Water Baffle #2	1		801234590096

3.8	Evaporator Water Baffle #3	1		801234590097
3.9	Evaporator Fixing Plate #1	1		801234590098
3.10	Evaporator Fixing Plate #2	1		801234590099
3.11	Evaporator Junction Plate	1		802134590032
4	Chasiss assembly	1		801233590133
5	Supporter	2		801234590090
6	Fan components	1		802433590012
6.1	Right Volute Wind Wheel	1		801200200040
6.2	Indoor Motor	1		802400400736
7	Fan Motor Fixing plate assembly	1		801239390034
7.1	Fan Motor Fixing plate	1		801239390035
7.2	Wind Wheel Fixed Block	2		801234590106
7.3	Fixed plate on air duct	1		801239390037
7.4	Stator	2		801239390036
7.5	air duct left stationary plate	1		801239390025
7.6	air duct right stationary plate	1		801239390026
8	Electric control cover assembly	1		801233590139
9	ELectronic Control Components	1		803333590024
9.1	ELectronic Control Mounting Plate	1		801234590202
9.2	Main Board	1		803300301063
9.3	Transformer	1		802300200079
10	Water pan supporter assembly	4		801234590083
11	Upper side plate assembly	1		801233590135
12	Pipe Cover plate assembly	1		801234590081
13	Lower side plate assembly	1		801233590137

Model: LUC42
 Power supply: 208/230V_1Ph_60HZ

ComfortStar®

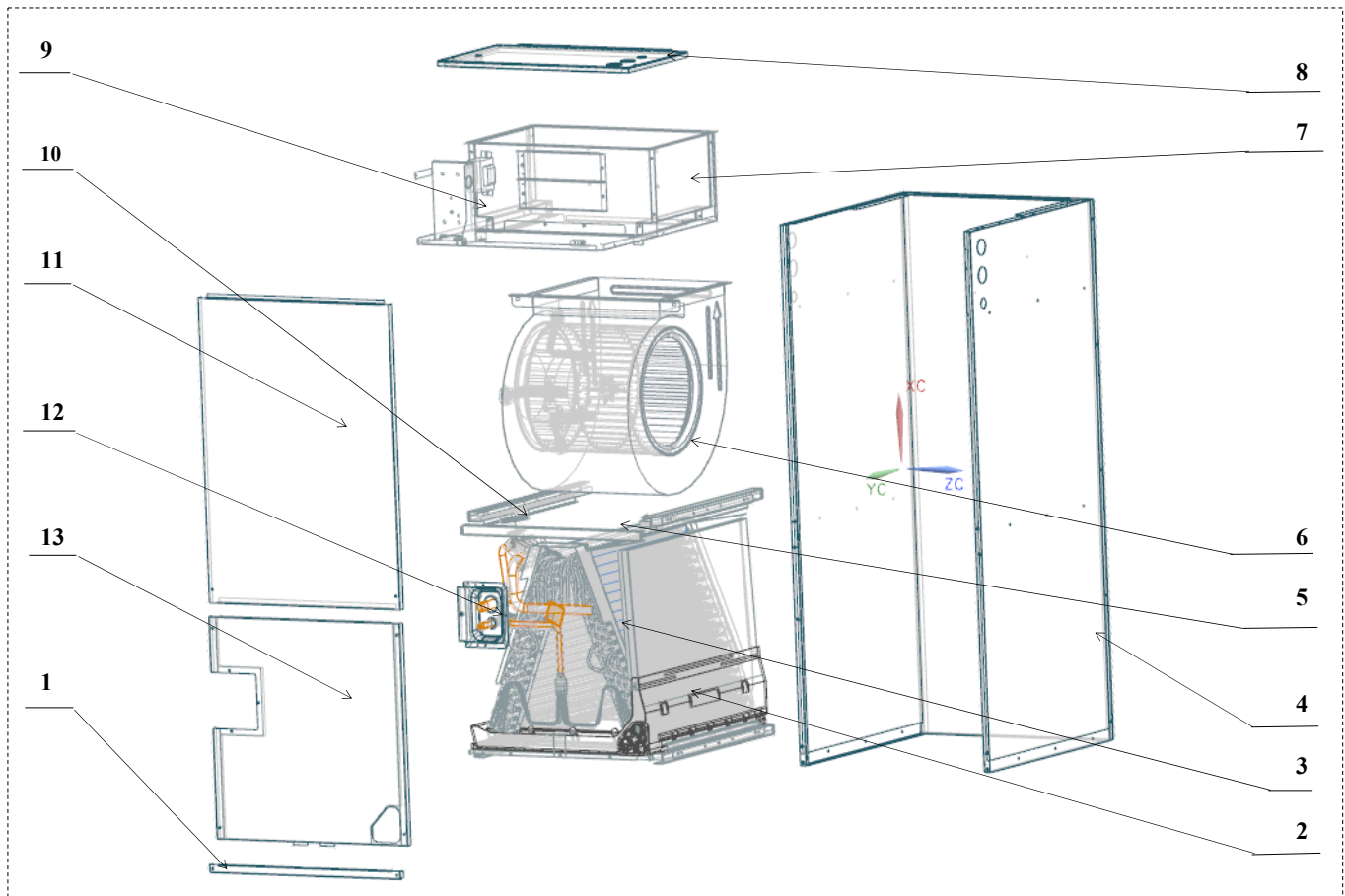
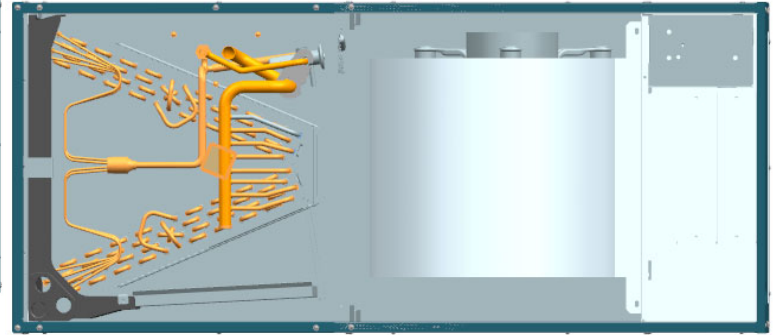
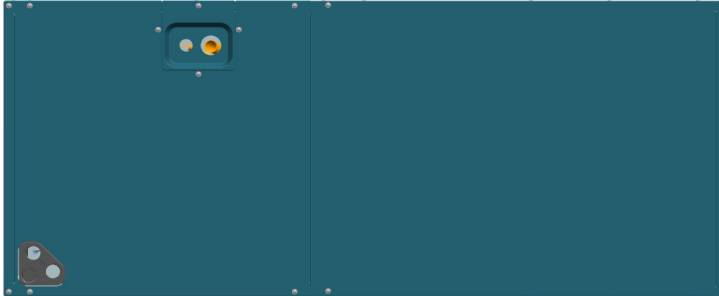

No.	Part Name	Quantity	Sale code	BOM code
1	Filter Cover plate	1		801234590089
2	Water pan components	1		801232590060
2.1	Water pan# 1	1		801134590002
2.2	Water pan# 2	1		800734590102
2.3	Water pan fixed block	1		801234590091
2.4	Water pan brace	2		801234190193
3	Evaporator components	1		801533790013
3.1	Air header Assembly	1		801633590039

3.2	Diverter Assembly	1		801633790009
3.3	Evaporator	2		801533590038
3.4	Evaporator Baffle	1		801239390040
3.5	Evaporator Baffle	1		801233590156
3.6	Evaporator Water Baffle #1	2		801234590095
3.7	Evaporator Water Baffle #2	1		801234590096
3.8	Evaporator Water Baffle #3	1		801234590097
3.9	Evaporator Fixing Plate #1	1		801234590098
3.10	Evaporator Fixing Plate #2	1		801234590099
3.11	Evaporator Junction Plate	1		802134590032
4	Chasiss assembly	1		801233590133
5	Supporter	2		801234590090
6	Fan components	1		802433790003
6.1	Right Volute Wind Wheel	1		801200200040
6.2	Indoor Motor	1		802400400735
7	Fan Motor Fixing plate assembly	1		801239390034
7.1	Fan Motor Fixing plate	1		801239390035
7.2	Wind Wheel Fixed Block	2		801234590106
7.3	Fixed plate on air duct	1		801239390037
7.4	Stator	2		801239390036
7.5	air duct left stationary plate	1		801239390025
7.6	air duct right stationary plate	1		801239390026
8	Electric control cover assembly	1		801233590139
9	ELectronic Control Components	1		803333590024
9.1	ELectronic Control Mounting Plate	1		801234590202
9.2	Main Board	1		803300301063
9.3	Transformer	1		802300200079
10	Water pan supporter assembly	4		801234590083
11	Upper side plate assembly	1		801233590135
12	Pipe Cover plate assembly	1		801234590081
13	Lower side plate assembly	1		801233590137