

Model CCRT90-3

Power 220V 3N~ 60Hz

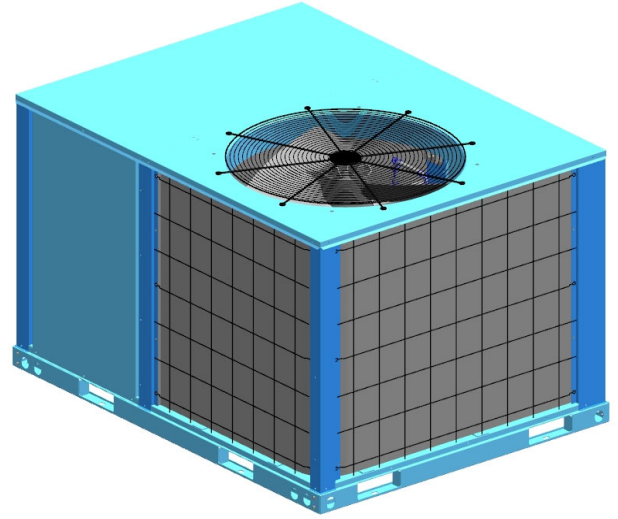

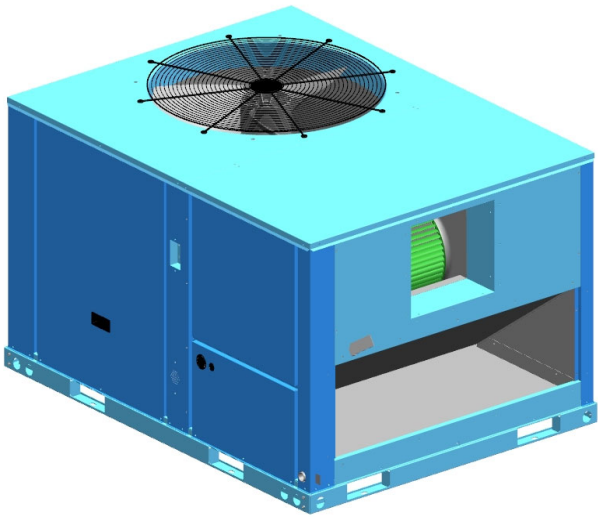

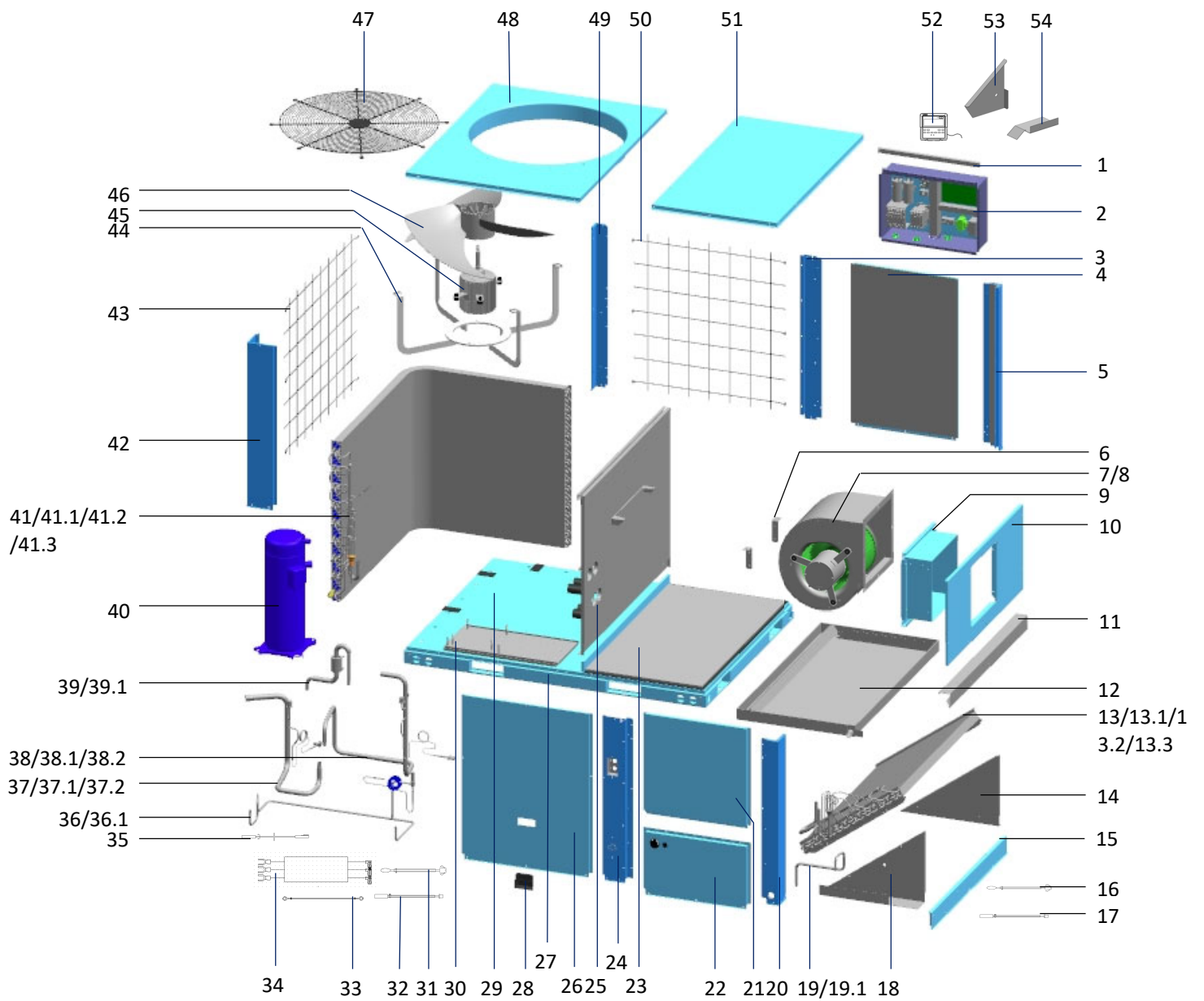
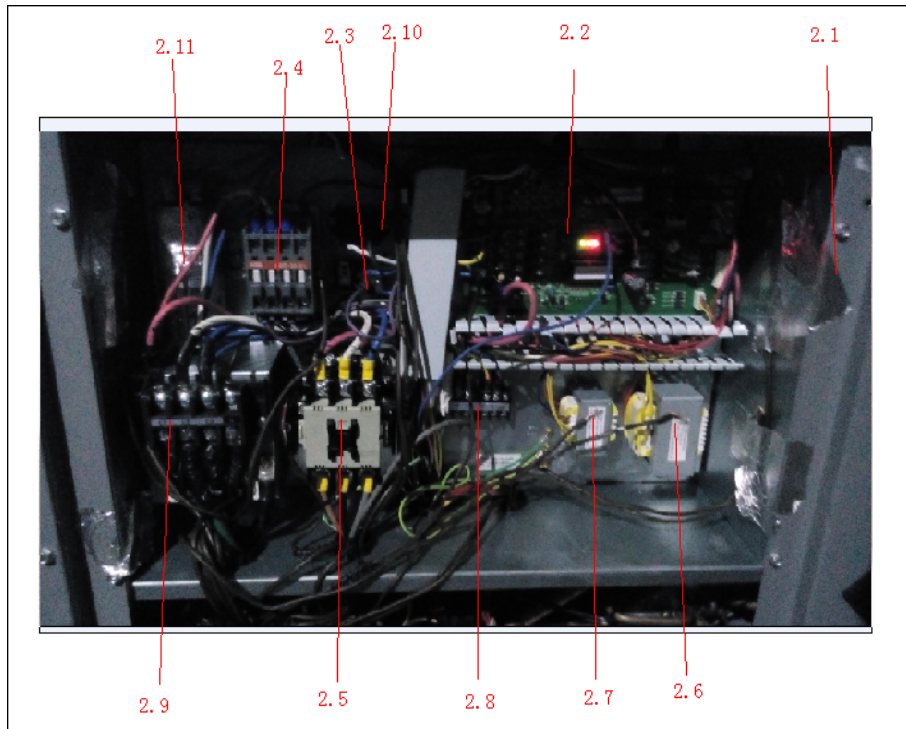

No.	Part Name	Quantity	BOM code	Price(\$\$)	Remark
1	E-part box fix support	1	201296190403		
2	E-part control box ass'y	1	203396190048		
2.1	E-part control box	1	201296190394		
2.2	Main control board	1	201396190044		
2.3	Relay	1	202300800003		
2.4	Contactor	1	202300800110		
2.5	AC contactor	1	202300830621		
2.6	Linear transformer	1	202300930283		
2.7	Transformer	1	202300930287		
2.8	Terminal block 6P	1	202301400219		
2.9	Wire joint	1	202301450101		

2.10		Terminal block	1	202301450122		
2.11		Capacitor	1	202401000410		
3		Middle pole 2	1	201296190416		
4		Side cover 2	1	201296190410		
5		Right rear pole	1	201296190432		
6		Wheel fix plate	2	201296190405		
7		Centrifuge fan	1	201200300892		
8		Motor	1	202400401764		
9		Fan support plate	1	201296190420		
10		Air supply cover	1	201296190418		
11		Evaporator sealplate ass'y	1	201296190398		
12		Drain pan ass'y	1	201296190425		
13		Evaporator ass'y	1	201596190039		
13.1		Evaporator	1	201596190040		
13.2		Evaporator input pipe ass'y	1	201696190359		
13.3		Evaporator output pipe ass'y	1	201696190367		
14		Evaporator fix support 2	1	201296190451		
15		Drain pan baffle	1	201296190430		
16		Indoor temp. sensor ass'y	1	202301300212		T1
17		Condenser pipe temp.sensor ass'y	1	202301300753		T3
18		Evaporator fix support 1	1	201296190452		
19		Throttle	1	201696190417		
19.1		One-way throttle	1	201600801500		
20		Right front pole	1	201296190433		
21		Side cover 3	1	201296190408		
22		Side cover 1	1	201296190412		
23		Base ass'y	1	201296190446		
24		Middle pole 1	1	201296190427		
25		Dummy plate	1	201296190435		
26		Side cover	1	201296190404		
27		Base	1	201296190448		
28		Handle	1	201148700003		
29		Base	1	201296190444		
30		Compressor base	1	201296190442		
31		Room Temp. sensor ass'y	1	202301300197		T4
32		Pipe Temp. sensor ass'y	1	202301300738		T2
33		Ground wire	1	202402150994		
34		Compressor joint wire	1	202496490035		
35		Discharge temperature sensor	1	202301600560		
36		Condenser output pipe ass'y	1	201696190372		
36.1		Unloading valve	1	201601600027		
37		Return air duct ass'y	1	201696190413		
37.1		Pressure switch	1	202301820021		
37.2		Joint	1	201696190410		
38		Exhaust pipe ass'y	1	201696190415		
38.1		Pressure switch	1	202301820042		
38.2		Joint	1	201696190410		
39		Evaporator output pipe ass'y	1	201696190370		
39.1		filter	1	201600900781		
40		Compressor	1	201401401290		
41		Condenser ass'y	1	201596190037		
41.1		Condenser	1	201596190038		
41.2		Condenser input pipe	1	201696190343		
41.3		Condenser output pipe	1	201696190347		
42		Front left pole	1	201296190406		

43		Net 1	1	201296190402		
44		Motor support	1	201296190407		
45		Motor	1	202400801098		
46		Fan	1	201200300225		
47		Grille	1	201219900914		
48		Top cover ass'y	1	201296190464		
49		Right rear pole	1	201296190431		
50		Net 2	1	201296190401		
51		Top cover	1	201296190414		
52		Wired controller	1	203355100009		
53		Evaporator sealplate 2	1	201296190460		
54		Evaporator sealplate 1	1	201296190461		
55		Refrigerant	3.8	200500100003		