

Exploded View

Model CDP36-15

ComfortStar®

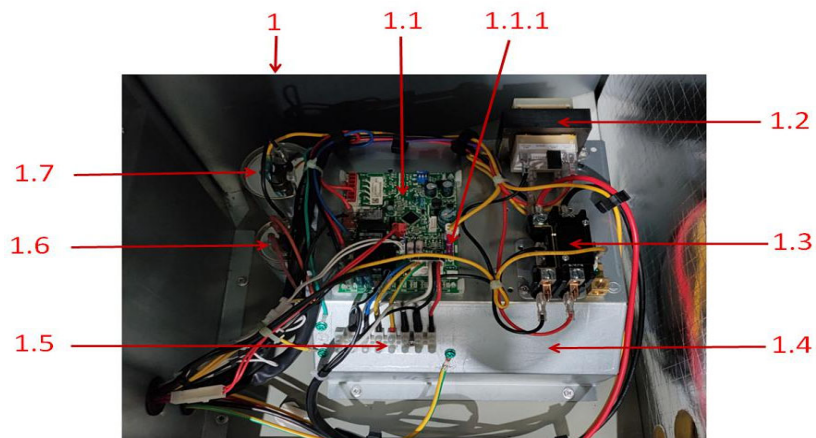

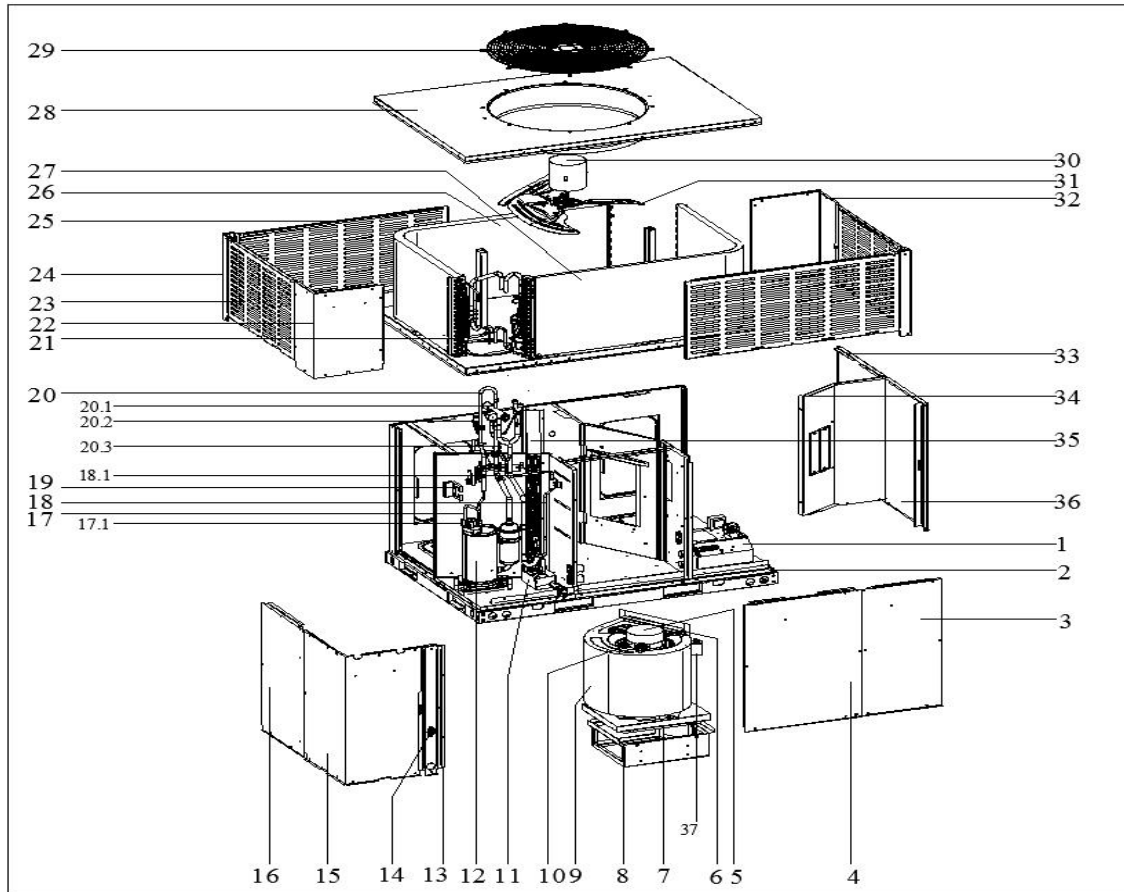

EX_ID	Spare Parts Code	Part Name(EN)	Qty.	Price	Remarks
1	17227700000960	E-part box assembly	1		
1.1	17127700000970	Main control board assembly	1		
1.1.1	11203001001353	Fuse	1		
1.2	11203103000194	Linear Transformer	1		
1.3	11203502000032	AC contactor	1		
1.4	12227700006629	Electrical appliance mounting plate assembly	1		
1.5	17400401000196	Wire joint, 8P	1		
1.6	17400103000152	Capacitor	1		
1.7	17400103000138	Capacitor	1		
2	12227700A07312	Chassis part	1		
3	12227700009001	Internal panel assembly	1		
4	12227700A07321	Internal panel assembly	1		
5	11002015011928	Brushless DC Motor	1		
6	12223000001932	Supporter subassembly of fan motor	3		
7	12227700006519	Wind wheel fixed plate	1		
8	12227700006515	Fan support board	1		
9	12200102000175	Centrifugal fan	1		
10	12223000001992	Supporter of fan motor	1		
11	12127700000117	Drainage pan assembly	1		
12	11103010019040	Fixed Speed Rotary Compressor	1		
13	12227700009003	Column assembly	1		
14	11201007000025	Room Temperature Sensor	1		
15	12227700A07334	Panel	1		
16	12227700A07340	Internal panel assembly	1		
17	15427700001990	Air discharge pipe assembly	1		
17.1	17400513000066	Discharge temp sensor	1		
18	15427700002290	Throttle assembly	1		
18.1	15500210004428	Two-way throttle valve	1		

19	12227700008907	Installation board	1		
20	15427700002271	Four-way valve assembly	1		
20.1	15500216000084	4-way valve	1		
20.3	17400516000089	Pressure switch	1		
21	11201007000412	Pipe Temperature Sensor	1		
22	12227700A07331	Column assembly	1		
23	12227700A07329	Protective plate assembly	2		
24	12227700008914	Column	2		
25	12227700A07323	Protective plate assembly	2		
26	15827700000750	B unit condenser assembly	1		
27	15827700000752	Condenser part	1		
28	12227700A07342	Top cover welding assembly	1		
29	12927700000341	protection net	1		
30	11002012000506	Single Phase Asynchronous Motor	1		
31	12200104000038	Fan	1		
32	12227700A07350	Column	1		
33	12227700A07343	Internal panel assembly	1		
34	12227700006518	Circuit board assembly duct	1		
35	15827700001229	Evaporator assembly	1		
36	12227700009012	Column assembly	1		