

Exploded View

Model CDP60-15-T

ComfortStar®

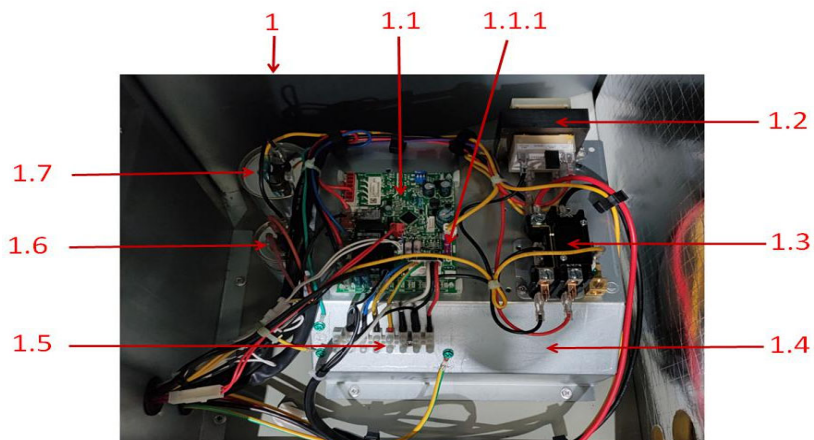

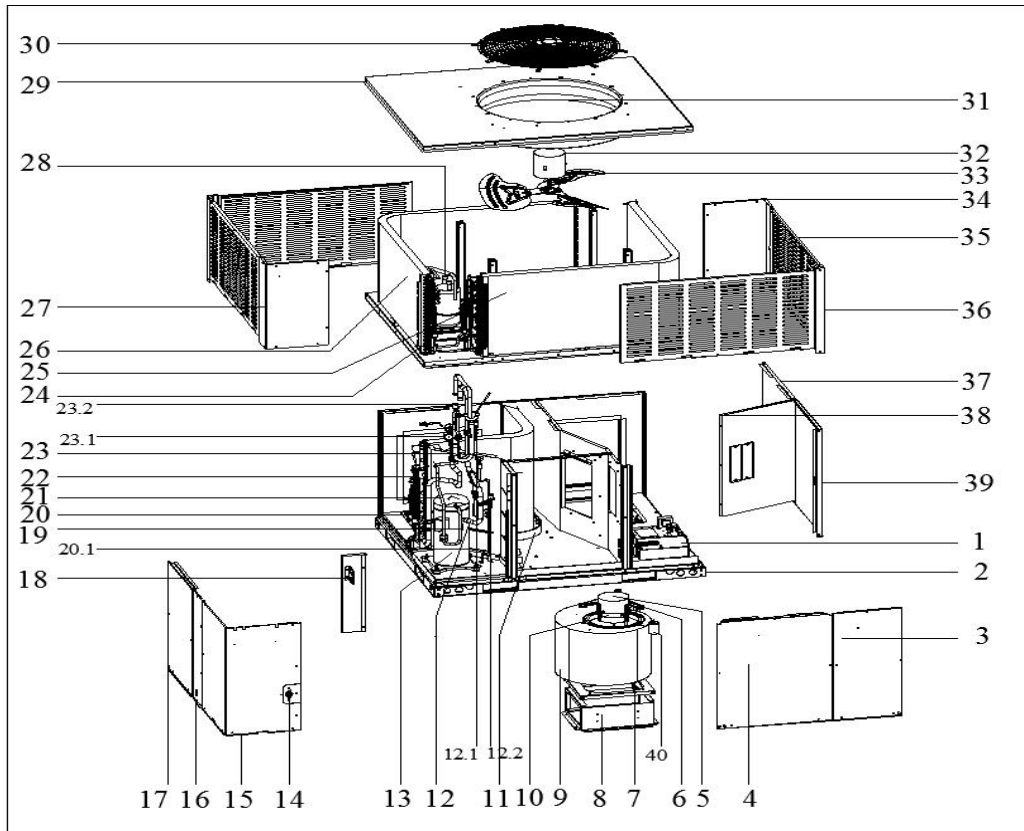

EX_ID	Spare Parts Code	Part Name(EN)	Qty.	Price	Remarks
1	17227700000958	E-part box assembly	1		
1.1	17127700000968	Main control board assembly	1		
1.1.1	11203001001353	Fuse	1		
1.2	11203103000194	Linear Transformer	1		
1.3	11203502000029	AC contactor	1		
1.4	12227700006629	Electrical appliance mounting plate assembly	1		
1.5	17400401000196	Wire joint, 8P	1		
1.6	17400103000151	Capacitor	1		
2	12227700A07357	Chassis part	1		
3	12227700009002	Internal panel assembly	1		
4	12227700A07367	Internal panel assembly	1		
5	11002015011927	Brushless DC Motor	1		
6	12223000001932	Supporter subassembly of fan motor	3		
7	12227700006164	Wind wheel fixed plate	1		
8	12227700006171	Fan support board	1		
9	12200101000213	Wind turbine parts	1		
10	12223000001992	Supporter of fan motor	1		
11	12127700000097	Drainage pan assembly	1		
12	15427700002011	Suction pipe assembly	1		
12.1	15427000001439	Fusible plug assembly	1		
12.2	17400516000089	Pressure switch	1		
13	11102010001498	Fixed Speed Scroll compressor	1		
14	11201007000025	Room Temperature Sensor	1		
15	12227700A07301	Panel	1		
16	12227700A07376	Column assembly	1		
17	12227700A07372	Internal panel assembly	1		
18	12227700008912	Installation board	1		
19	17400513000070	Discharge Temp. sensor	1		

20	15427700001994	Throttle assembly	1		
20.1	15500210004111	Throttle	1		
21	15427700001991	Air discharge pipe assembly	1		
22	15827700001151	Evaporator assembly	1		
23	15427700002010	Four-way valve assembly	1		
23.1	15500216000084	4-way valve	1		
23.2	17400516000101	Pressure switch	1		
24	11201007000412	Pipe Temperature Sensor	1		
25	15827700000712	B unit condenser assembly	1		
26	15827700000708	B unit condenser assembly	1		
27	12227700A07348	Column assembly	1		
28	15500508000082	Accumulator cylinder	1		
29	12227700A07333	Top cover welding assembly	1		
30	12927700000301	protection net	1		
31	12227700006170	Air guide ring	1		
32	11002012028483	Single Phase Asynchronous Motor	1		
33	12200104000122	Axial fan	1		
34	12227700A07314	Column	1		
35	12227700A07351	Protective plate assembly	4		
36	12227700006368	Column	2		
37	12227700009000	Internal panel assembly	1		
38	12227700006260	Circuit board assembly duct	1		
39	12227700009008	Column assembly	1		