

Exploded View

Model

CHF09CA(I)

ComfortStar®

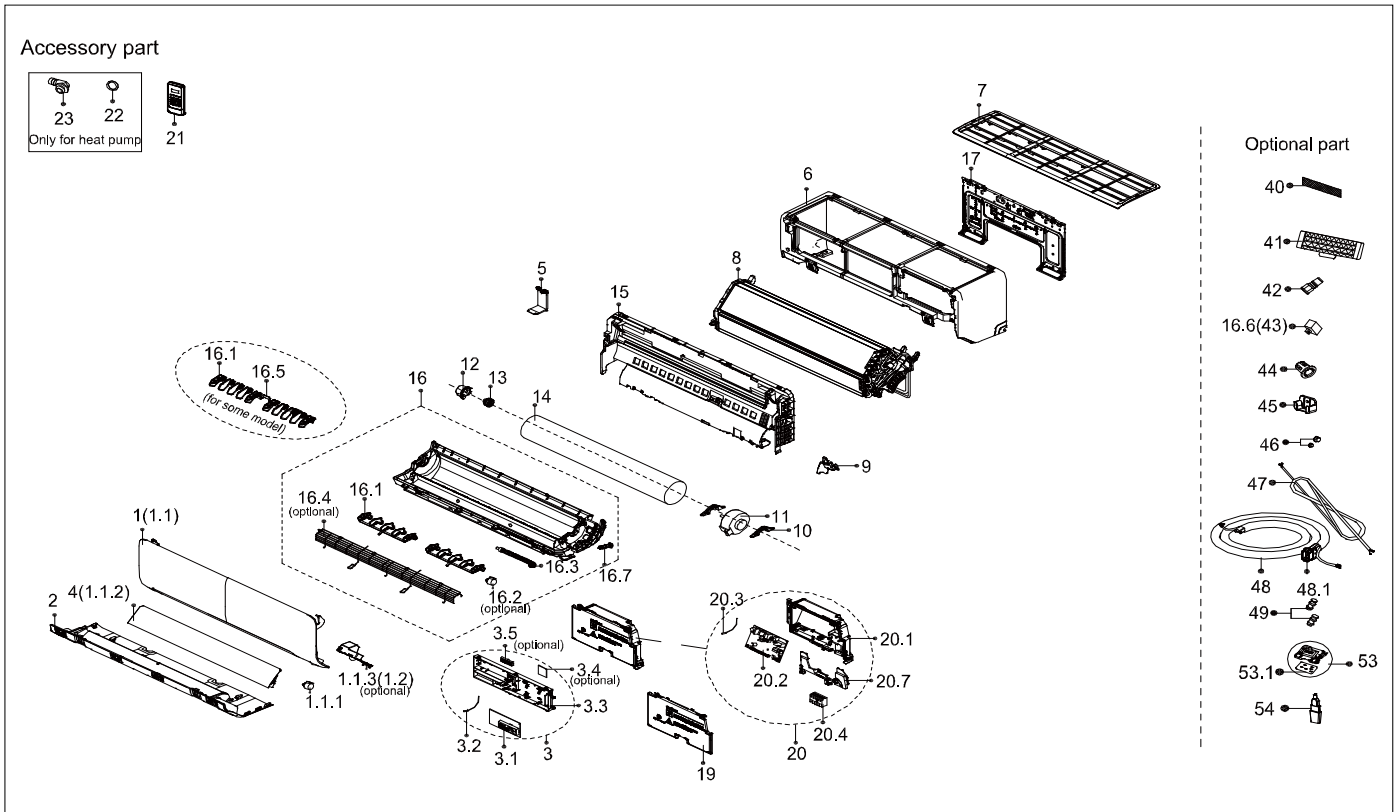

| EX_ID | Spare Parts Code | Part Name(EN) | Qty. | Price | Remarks |
|-------|------------------|--|------|-------|---------|
| 1 | 12122000026983 | Panel assembly | 1.0 | | |
| 1.1 | 12122000026984 | Panel assembly | 1.0 | | |
| 1.1.1 | 11002010000326 | Stepper motor | 1.0 | | |
| 1.1.2 | 12122000027051 | Horizontal louver | 1.0 | | |
| 2 | 12122000026607 | Panel assembly | 1.0 | | |
| 3 | 17222000032604 | Display box assembly | 1.0 | | |
| 3.1 | 17122000050213 | Display board assembly | 1.0 | | |
| 3.2 | 11201007003103 | Ambient temperature sensor subassembly | 1.0 | | |
| 3.3 | 12122000026921 | Display box | 1.0 | | |

| | | | | | |
|------|----------------|--|-----|--|--|
| 5 | 12122000026621 | Chassis supporter | 1.0 | | |
| 6 | 12122000026423 | Panel frame assembly | 1.0 | | |
| 7 | 12122000026428 | Air filter | 1.0 | | |
| 8 | 15822000011142 | evaporator assembly | 1.0 | | |
| 9 | 12122000026609 | Pipe clamp board | 1.0 | | |
| 10 | 12122000011994 | Fixing plate for fan motor | 2.0 | | |
| 11 | 11002015006201 | Motor | 1.0 | | |
| 12 | 12122000000350 | bearing holder | 1.0 | | |
| 13 | 12622000000131 | bearing base | 1.0 | | |
| 14 | 12100102000696 | Cross flow fan | 1.0 | | |
| 15 | 12122000026603 | Chassis assemble((above) | 1.0 | | |
| 16 | 12122000028661 | Chassis assemble((below) | 1.0 | | |
| 16.1 | 12122000026617 | louver | 4.0 | | |
| 16.1 | 12122000026616 | louver | 6.0 | | |
| 16.2 | 11002010001486 | Stepper motor | 1.0 | | |
| 16.3 | 12100501000032 | Drain pipe joint | 1.0 | | |
| 16.4 | 12922000001991 | Air outlet Protective wire | 1.0 | | |
| 16.5 | 12122000026618 | Connecting rod of louver | 1.0 | | |
| 16.7 | 12622000000030 | Drainage plug | 1.0 | | |
| 17 | 12222000013705 | Installation plate | 1.0 | | |
| 19 | 12122000026601 | Cover of electronic control box | 1.0 | | |
| 20 | 17222000033142 | Structural components of indoor electric control | 1.0 | | |
| 20.1 | 12122000026606 | Electronic control box | 1.0 | | |
| 20.2 | 17122000050729 | Indoor main control board subassembly | 1.0 | | |
| 20.3 | 11201007003445 | Pipe temperature sensor subassembly | 1.0 | | |
| 20.4 | 17400401000577 | Terminal block | 1.0 | | |
| 20.7 | 12122000026605 | Electric control box bracket | 1.0 | | |
| 21 | 17317000007564 | remote controller | 1.0 | | |
| 22 | 12600701000039 | Sealing ring | 1.0 | | |
| 23 | 12100509000061 | Drain pipe joint | 1.0 | | |
| 40 | 12100204000685 | Air freshening filter | 1.0 | | |
| 42 | 15500209000001 | Detection valve | 1.0 | | |
| 46 | 15500406000016 | Copper nut | 1.0 | | |
| 46 | 15500406000012 | Copper nut | 1.0 | | |