

Exploded View

Model

DKP60-1

ComfortStar®

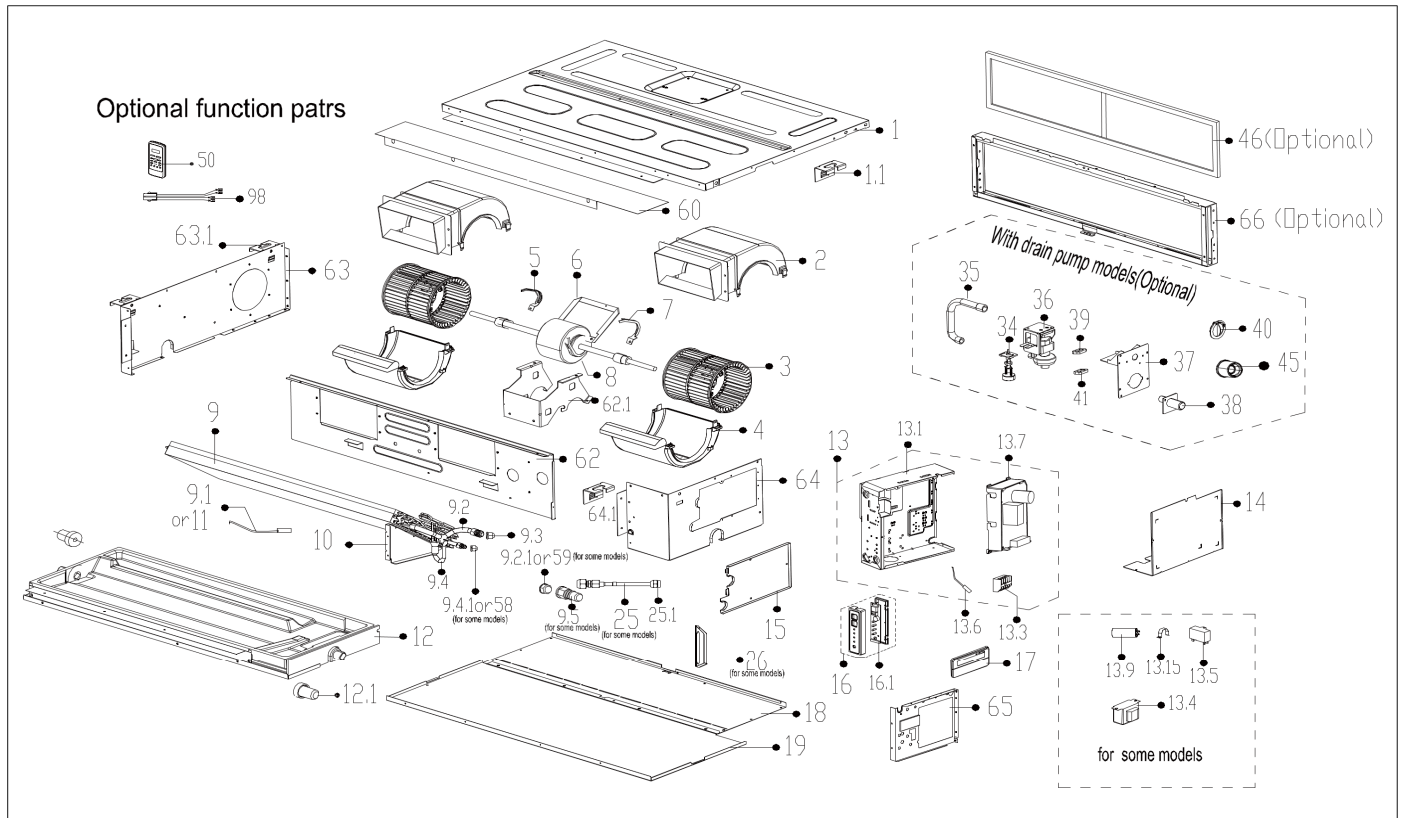

EX_ID	Spare Parts Code	Part Name(EN)	Qty.	Price	Remarks
1	12223000008649	Chassis subassembly	1		
1.1	12223000012926	Hook	1		
2	12123000000941	top volute	2		
3	12100103000664	centrifuge fan	2		
4	12123000002520	Lower volute assembly	2		
5	12222500000253	Fan motor axes clamp (left)	1		
6	12223000007948	Fan motor fixing board	1		
7	12222500000255	Fan motor axes clamp (right)	1		
8	11002012022222	Single Phase Asynchronous Motor	1		

9	15823000004603	Evaporator Assembly	1		
9.1	11201007000136	Pipe Temperature Sensor	1		
9.2	15123000009676	Evaporator outlet pipe subassembly	1		
9.3	15500404000008	Pipe Nut	1		
9.4	15123000012647	Evaporator inlet pipe subassembly	1		
9.5	15500209000002	Detection valve	1		
10	12223000008027	Evaporator right support board subassembly	1		
12	12823000000210	Water collector assembly	1		
12.1	12600801000883	Rubber plug	2		
13	17223000005136	E-Parts Box assembly	1		
13.1	12223000011048	Electronic control box	1		
13.3	17400401000121	Terminal	1		
13.4	11203103000002	Linear Transformer	1		
13.6	11201007000283	Room Temperature Sensor	1		
13.7	17123000002832	Duct main control board subassembly	1		
13.9	17400103000007	Capacitor of compressor	1		
13.15	12200203000007	Capacitor clip	1		
14	12223000008047	Cover of electronic control box	1		
15	12223000007987	Pipe clamp board subassembly	1		
16	17223000000003	Duct display board subassembly	1		
16.1	17123000002712	Duct display board subassembly	1		
17	17317100002996	Wired controller	1		
18	12223000008029	Rear cover subassembly	1		
19	12223000008028	Top cover subassembly	1		
25	15423000004358	Throttle valve subassembly	1		
25.1	15500406000010	Copper nut	1		
26	12223000000112	Right clapboard strengthen board	1		
50	17317000A64434	Remote controller	1		
58	15500406000010	Copper nut	1		
59	15500406000008	Copper nut	1		
60	12223000008653	Rear beam subassembly	1		
62	12223000008660	Middle beam subassembly	1		
62.1	12223000010129	Fan motor support	1		
63	12223000008651	Left clapboard subassembly	1		

63.1	12223000012927	Hook	2		
64	12223000008650	Right clapboard subassembly	1		
64.1	12223000012927	Hook	1		
65	12223000008647	Right side plate	1		
66	12223000008648	Right clapboard subassembly	1		