

# Exploded View

**Model** 32HP12CD35

**ComfortStar®**

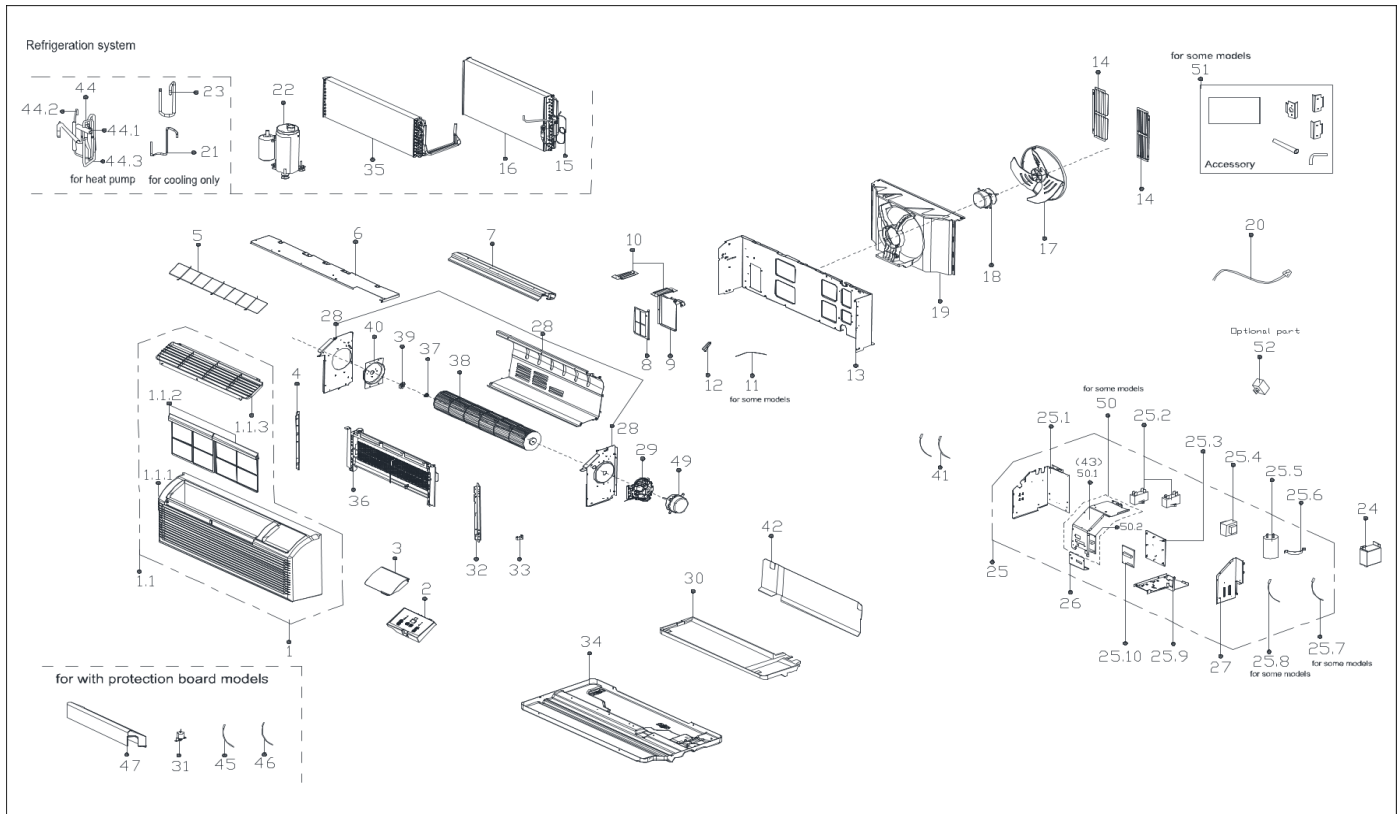

EX_ID	Spare Parts Code	Part Name(EN)	Qty.	Price	Remarks
1	12120300007267	Panel frame assembly	1		
1.1	12120300000261	Panel frame subassembly	1		
1.1.1	12120300003185	Panel frame	1		
1.1.2	12120300A03940	Air filter	2		
1.1.3	12120300003184	Air outlet frame	1		
2	17220300005930	Display box subassembly	1		
3	12120300A22166	Cover of control panel	1		
5	12220300000533	Rear net	1		
6	12220300005439	Front cover assmbl	1		

7	12220300000518	Volute shell	1		
8	12120300001288	Filter	1		
9	12220300000262	Fresh air door	1		
10	12220300000566	Linker for front separating board	2		
12	12220300000312	Connecting rod of fresh air door	1		
13	12220300005438	Front separating board subassembly	1		
14	12220300000517	Horizontal louver	2		
15	15120300007549	Capillary assembly	1		
16	15820300002883	Condenser assembly	1		
17	12100105000064	Axial flow fan	1		
18	11002012033914	Single Phase Asynchronous Motor	1		
19	12120300000552	Rear separating	1		
20	17401202000107	American Standard Power Cord	1		
22	11103010021756	Fixed Speed Rotary Compressor	1		
24	12220300000277	Line Board of Electrical Control Box	1		
25	17220300006016	Electronic control box subassembly	1		
25.1	12220300000278	Rear Plate of Electrical Control Box	1		
25.2	17400101A00484	Fan motor capacitor	1		
25.3	12120300007046	Bracket of main control board	1		
25.4	11203103000087	Linear Transformer	1		
25.5	17400103000055	Compressor Capacitor	1		
25.6	12200203000018	Capacitor clip	1		
25.7	11201007003443	Room Temperature Sensor	1		
25.8	11201007003444	Pipe Temperature Sensor	1		
25.9	12220300000274	Base Plate of E-Parts Box	1		
25.10	17120300005834	Main control board subassembly	1		
26	12220300A00131	Dialing Cover of E-Parts Box	1		
27	12220300000303	Cover of electronic control box	1		
28	12220300005579	Supporter subassembly of air passage	1		
29	12120300007064	Motor cover assembly	1		
30	12820300000028	Condenser water tray	1		
31	17400510000003	Drain valve	1		
33	12220300000560	Hook of Panel	2		
34	12220300003658	Chassis assembly	1		

35	15820300003882	Evaporator assembly	1		
36	17402004001560	strip heater	1		
37	12622000000012	Bearing base	1		
38	12100102000055	Cross flow fan	1		
39	12220300000557	Cover of Bearing bracket	1		
40	12220300000514	Wind baffle board	1		
41	11201007003124	Discharge Temperature Sensor	1		
41	11201007003427	Discharge Temperature Sensor	1		
42	12920300000002	Condenser water tray	1		
44	15420300000595	4-way valve assembly	1		
44.1	15500216000008	4-way valve	1		
44.2	15120300007553	Discharge pipe	1		
44.3	15120300007531	Suction pipe assembly	1		
45	11201007003424	Room Temperature Sensor	1		
46	11201007003447	Pipe Temperature Sensor	1		
47	12220300000540	Side plate	1		
49	11002015018132	Brushless DC Motor	1		
50	17122000059629	Dial switch subassembly	1		
50.1	12220300000272	Cover of electronic control box	1		
50.2	17122000059306	Switchboard subassembly	1		