

# Exploded View

Model CPA-36DUB

# ComfortStar®

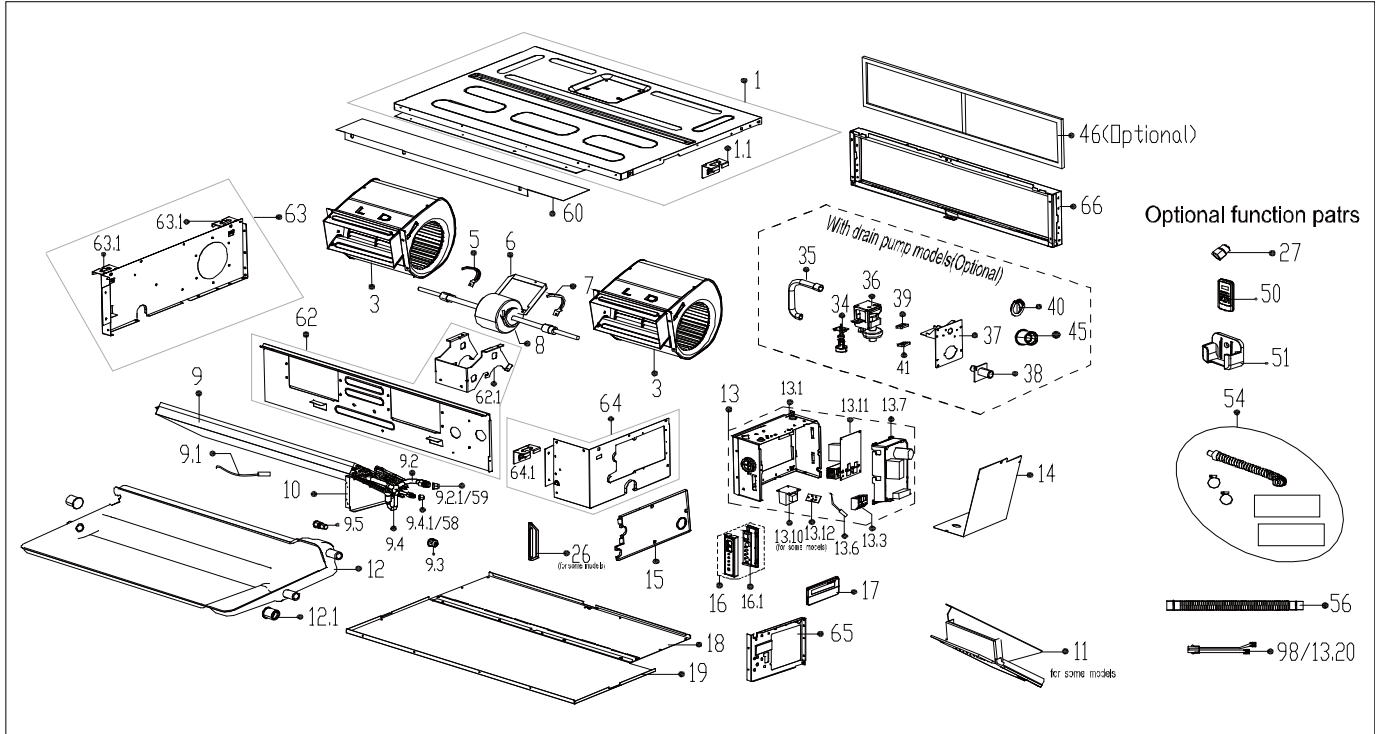

EX_ID	Spare Parts Code	Part Name(EN)	Qty.	Price	Remarks	Update
1	12223000011149	Chassis subassembly	1			
1.1	12223000012926	Hook	1.0			
3	12200101000173	centrifuge fan assembly	2			
5	12222500000253	Fan motor axes clamp (left)	1			
6	12223000006639	Fan motor fixing board	1			
7	12222500000255	Fan motor axes clamp (right)	1			
8	11002015002541	Brushless DC Motor	1			
9	15823000004564	Evaporator assembly	1			
9.1	11201007000136	Pipe Temperature Sensor	1.0		CSN after*23222xxxx	20230616
/					JSN after*18317xxxx	20230616
	11201007000136				JSN after*17B06xxxx	20230616
9.2	15123000008702	Evaporator outlet pipe subassembly	1.0			
9.3	15500404000005	Pipe Nut	1.0			
9.4	15123000011147	Evaporator inlet pipe subassembly	1.0			
9.5	15500209000002	Detection valve	1.0			
10	12223000008851	Evaporator right support board subassembly	1			

12	12223000008857	Water collector assembly	1			
12.1	12600801000543	Rubber plug	2.0			
13	17223000004396	Duct electronic control box subassembly	1			
13.1	12223000011047	Electronic control box	1.0			
13.3	17400401000085	Wire joint	1.0			
13.6	11201007000283	Room Temperature Sensor	1.0			
13.7	17123000003453	Duct main control board subassembly	1.0			
13.10	17400306000070	Reactor	1.0			
13.11	17122000030548	Inverter module subassembly	1.0			
13.20	17401203003071	HV Junction Cable subassembly	1.0			
14	12223000009109	Electrical Control Box Cover Subassembly	1			
15	12223000A03149	Pipe clamp board subassembly	1			
16	17223000000003	Duct display board subassembly	1			
16.1	17123000002712	Duct display board subassembly	1.0			
17	17317100003015	Wired controller	1			
18	12223000008858	Rear cover subassembly	1			
19	12223000008854	Top cover subassembly	1			
26	12223000006643	Right clapboard strengthen board	1			
34	11201005000006	Water level sensor	1			
35	12623000000003	Rubber tube	1			
36	11001010000063	Induction Pump	1		JSN after*22217xxxx	20230616
	17400802000021				JSN after*17B06xxxx	20230616
37	12223000A03150	Exhaust pump subassembly	1			
39	12622500000004	Drain pump rubber washer	1			
41	12622500000003	Drain pump rubber washer	1			
45	12600801000543	Rubber plug	1			
46	12123000A00299	Air filter	1			
50	17317000A64087	Remote controller	1		JSN after*22217xxxx	20230616
	17317000A16345				JSN after*17B06xxxx	20230616
51	12122000029201	Bracket of remote Controller	1			
54	12011600A00310	Accessory kit	1			
56	12100510000021	Drain pipe	1			
58	15500406000010	Copper nut	1			
59	15500406000003	Copper nut	1			
60	12223000008855	Front beam subassembly	1			
62	12223000008856	Middle beam subassembly	1			
62.1	P0000000068313	Fan motor support	1.0			
63	12223000011158	Left clapboard subassembly	1			
63.1	12223000012927	Hook	2.0			
64	12223000011154	Right clapboard subassembly	1			
64.1	12223000012927	Hook	1.0			
65	12223000008114	Right side plate	1			

66	12223000A03128	Right clapboard subassembly	1			
----	----------------	-----------------------------	---	--	--	--