

MODEL MRR24-410-G  
POWER 220/1/60

ComfortStar®

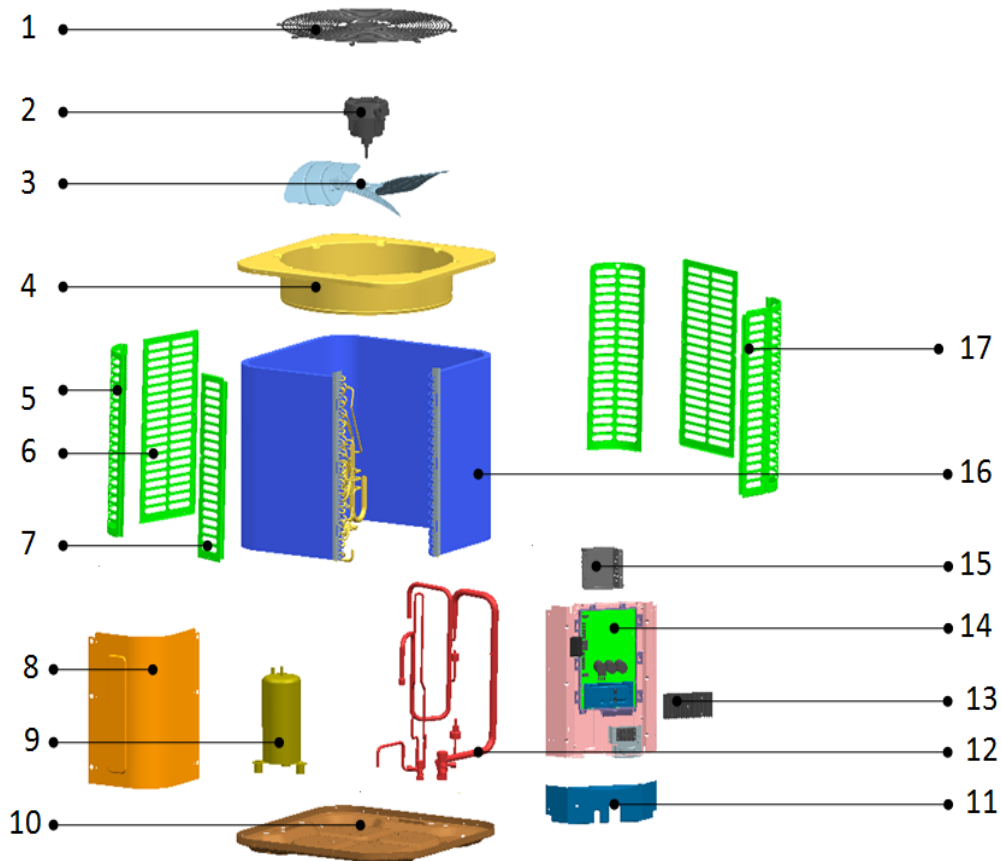
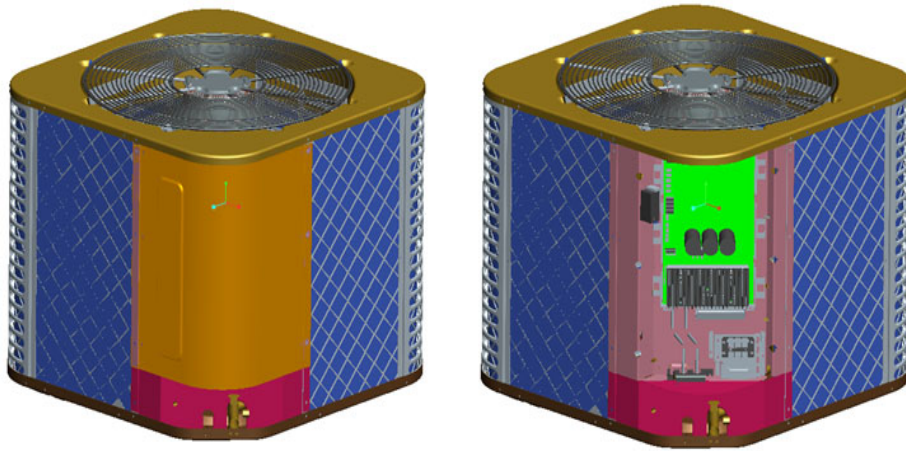

No.	Part Name	Quantity	Sale code	BOM code	Remark
1	Cover net	1		802925490001	
2	Outdoor motor	1		802400400766	
3	Axial-flow fan	1		802925490002	
4	Top cover assembly	1		801225490037	

5	Support board	3		801224290030	
6	back side panel	2		801224290063	
7	Left side panel	1		801224290067	
8	Top panel	1		801239090251	
9	Compressor	1		801401400168	
10	Chassis assembly	1		801225490186	
11	Left side panel	1		801239090252	
12	copper pipes assy	1		801633490321	
12.1	Welding assy for High pressure valv	1		801639090321	
12.1.1	Connection pipe for High pressure	1		801639090322	
12.1.2	Service valve	1		801600900069	
12.2	Welding assy for Discharge pipe	1		801633490322	
12.2.1	pressure switch	1		802300900041	
12.2.2	Discharge pipe	1		801633490324	
12.3	Welding assy for low pressure valv	1		801633490323	
12.3.1	Connection pipe for low pressure v	1		801633490325	
12.3.2	Service valve	1		801600900072	
12.3.3	Pressure sensor	1		802339090007	
12.3.4	subcooling pipe	1		801634490204	
12.4	Refrigerant cooling pipe	1		801632890138	
13	Cooling pipe cover plate	1		802939090003	
14	E part assy	1		803332890026	
14.1	ODU display board	1		802301900002	
14.2	Fan motor capacity	1		802401100094	
14.3	communication block install plate	1		801139090004	
14.4	Main board install plate	1		801139090003	
14.5	E-part install board weld assy	1		801239090253	
14.6	terminal block install plate	1		801239090254	
14.7	terminal block	1		802401800129	
14.8	IPM modular board	1		803300301103	
15	Reactor	1		802300300043	
16	condenser assy	1		801533490084	
16.1	condenser input pipe	1		801633490290	
16.2	condenser output pipe	1		801633490289	
16.3	condenser	1		801534490087	
17	right side panel	1		801224290065	