

MODEL MRR60-410-G
POWER 220/1/60

ComfortStar®

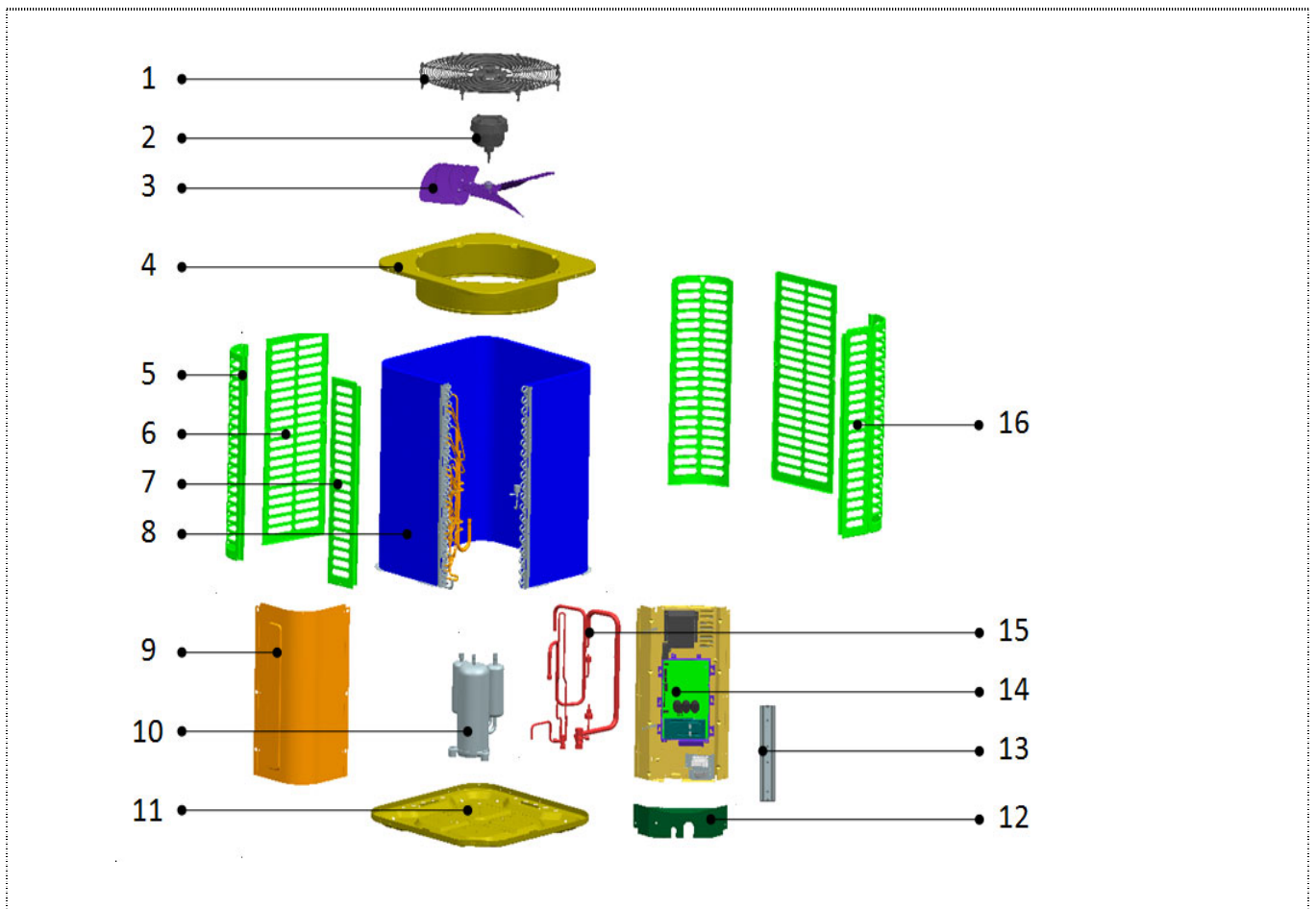
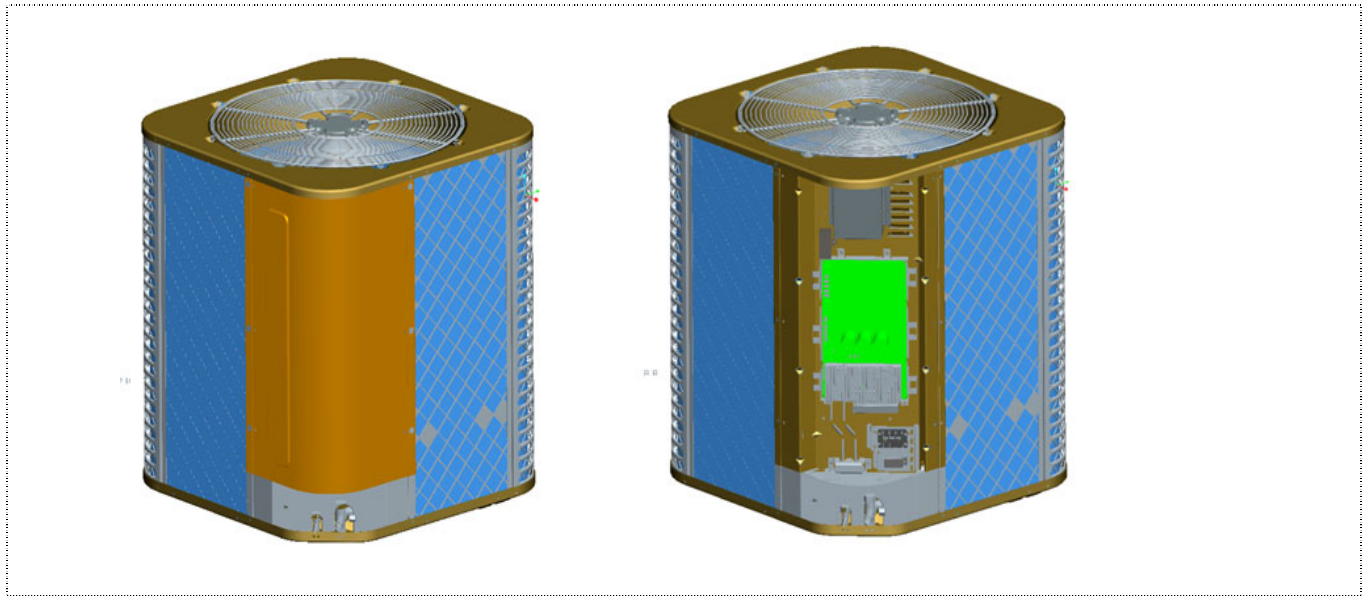

No.	Part Name	Quantity	Sale code	BOM code	Remark
1	Cover net	1		802925490001	
2	Outdoor motor	1		802400300077	
3	Axial-flow fan	1		801200200055	

4	Top cover assembly	1		801225490037	
5	Support board	3		801225490047	
6	back side panel	2		801225490039	
7	Left side panel	1		801225490051	
8	condenser assy	1		801534490091	
8.1	condenser input pipe	1		801634490195	
8.2	condenser output pipe	1		801634490196	
8.3	condenser	1		801534490094	
9	upper side panel	1		801239090255	
10	Compressor	1		801400900053	
11	Chassis assembly	1		801225490186	
12	under side panel	1		801239090252	
13	Cooling pipe cover plate	1		802939090003	
14	E part assy	1		803339090065	
14.1	Main board install plate	1		801139090003	
14.2	ODU display board	1		802301900002	
14.3	terminal block	1		802401800129	
14.4	power cable	1		802401601643	
14.5	IPM modular board	1		802301700430	
14.6	Reactor	1		802300300055	
14.7	E-part install board weld assy	1		801239090306	
14.8	terminal block install plate	1		801239090254	
14.9	communication block install plate	1		801139090004	
15	copper pipes assy	1		801634490205	
15.1	Refrigerant cooling pipe	1		801639090317	
15.1.1	Welding assy for High pressure valve	1		801639090321	
15.1.2	Connection pipe for High pressure valve	1		801639090322	
15.1.3	Service valve	1		801600900069	
15.2	Welding assy for low pressure valve	1		801634490206	
15.2.1	Connection pipe for low pressure valve	1		801634490207	
15.2.2	Pressure sensor	1		802339090007	
15.2.3	Service valve	1		801600900101	
15.3	Welding assy for Discharge pipe	1		801634490208	
15.3.1	Discharge pipe	1		801634490209	
15.3.2	pressure switch	1		802300900041	
15.4	subcooling pipe	1		801634490204	
16	right side panel	1		801225490045	