

Exploded View

Model CGS09CA(O)

ComfortStar®

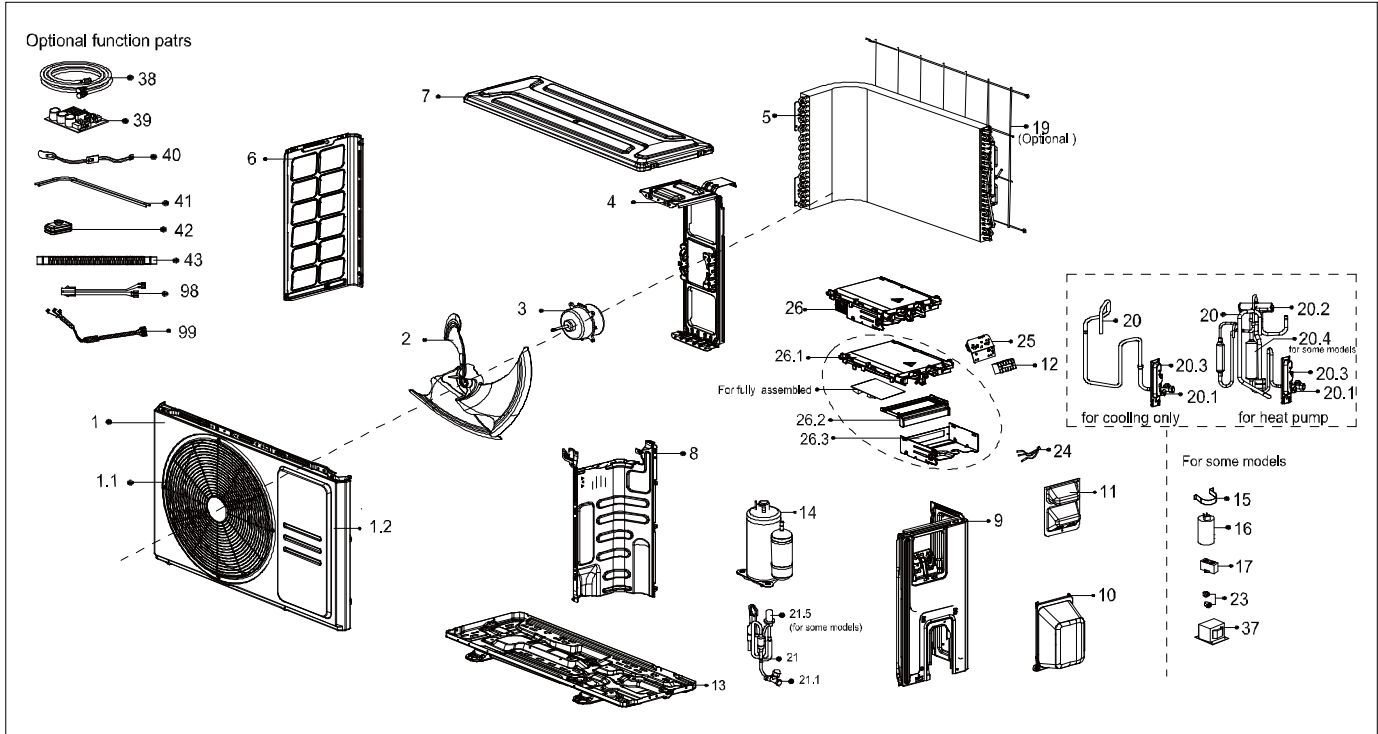

EX_ID	Spare Parts Code	Part Name(EN)	Qty.	Price	Remarks	Update
1	12222000A06317	Front panel assembly	1			
1.1	12222000A06091	Air outlet grille	1.0			
1.2	12222000A06318	Front panel	1.0			
2	12100105000961	Axial flow fan	1			
3	11002015012128	Brushless DC Motor	1			
4	12222000013233	Supporter of fan motor	1			
5	15822000010520	Condenser assembly	1			
6	12222000013238	Left supporter	1			
7	12222000013240	Top cover assembly	1			
8	12222000013665	Partition board assembly	1			
9	12222000013225	Right clapboard assembly	1			
10	12122000007150	Water collector	1			
11	12222000010966	Big handle assembly	1			
12	17400401000068	Terminal	1			
13	12222000013431	Chassis assembly	1			
14	11103020005082	DC Inverter rotary compressor	1			

19	12222000015606	Rear net	1			
20	15422000022236	4-way Valve Assembly	1		JSN after *22230xxxx	20230608
	15422000019415				JSN after *21A23xxxx	
20.1	15500204000021	Gas valve	1.0			
20.2	15500216002143	4-way valve	1.0		JSN after *22230xxxx	20230608
	15500216000341				JSN after *21A23xxxx	
20.3	12222200005738	Valve plate	1.0			
20.4	15122000026302	Muffler Subassembly	1.0			
21	15422000019414	Liquid valve assembly	1.0			
21.1	15500208000046	Liquid valve	1.0			
24	11201011000067	Combination sensor	1.0			
25	12222000002259	Terminal board	1.0			
26	17222000039286	Electronic control box subassembly	1.0		CSN after *22324xxxx	20230608
	15422000022236				JSN after *22319xxxx	
26.1	/	Support of electronic control box	1.0		CSN after *23324xxxx	
	12122000024223				JSN after *21A23xxxx	
26.2	12122000024222	Fixing board	1.0			
26.3	12222000012106	Electronic installing box subassembly	1.0			
26.5	17122000061160	Outdoor main control board subassembly	1.0		CSN after *23324xxxx	20230608
37	17400306001263	Reactor	1			
38	15111600A00008	Connecting pipe assembly	1			
40	17402001000559	Crankcase electric heater	1			
41	17402002000465	Electric heating tube	1			
99	17401203012697	Compressor wire subassembly	1			