

Exploded View

Model LCM5-36-15

ComfortStar®

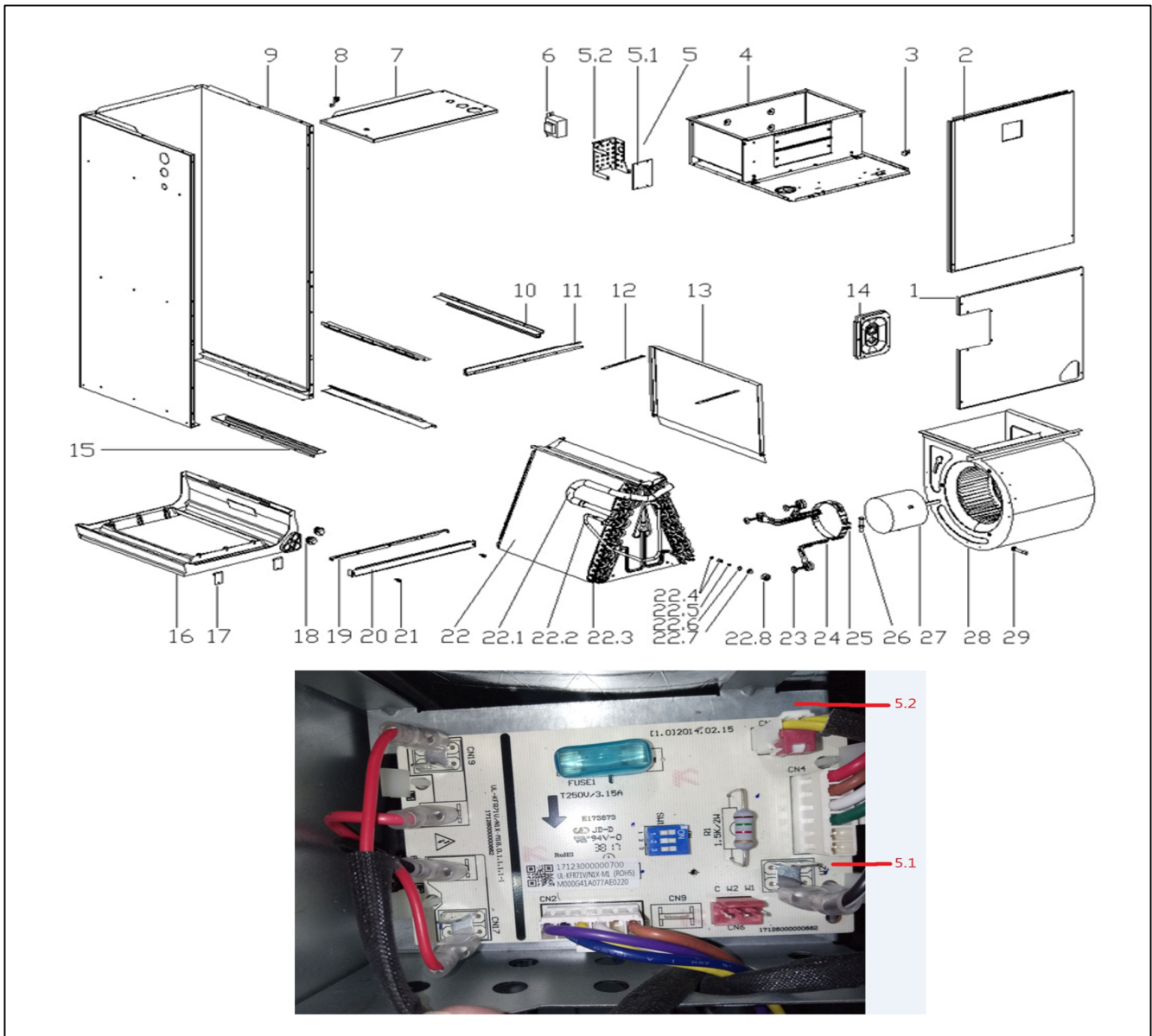

EX_ID	Spare Parts Code	Part Name(EN)	Qty.	Price	Remarks
1	12223000010765	Side panel assembly	1		

2	12223000002200	Side panel assembly	1		
3	11201708000008	Wiring Terminal	1		
4	12223000002121	Air duct ass'y	1		
5	17223000005676	E-part box assembly	1		
5.1	17123000000700	Electronic control(display) box subassembly of indoor unit	1		
5.2	12223000002167	Electric installation board	1		
6	11203103000141	Linear Transformer	1		
7	12223000002185	Side panel assembly	1		
8	12100304000011	Clamp	1		
9	12223000002355	Base ass	1		
10	12223000001935	Drainage pan supporting board	2		
11	12223000010772	Supporter assembly	1		
12	12223000010756	Drainage pan clamp	2		
13	12223000001204	Drainage pan	1		
14	12223000010789	Cover plate ass'y	1		
15	12223000010771	Drainage pan supporting board	2		
16	12123000000114	Drain pan ass'y	1		
17	12223000000028	Fixing board of water collector	2		
18	15500402000023	seal plug	2		
19	12223100000197	Supporting bar	1		
20	12223000002005	Cover board	1		
21	11301230000002	Screw	2		
22	15823000004408	Evaporator assembly	1		
22.1	15223000000165	Output pipe assembly	1		
22.2	15423000004540	Evaporator input pipe assembly	1		
22.3	15823000004405	Evaporator	2		
22.4	15500210000968	Throttle	1		
22.5	15500220000049	Piston	1		
22.6	12100901000010	Sealing ring	1		
22.7	15500302000014	Flange joint	1		
22.8	15500402000245	Nut	1		
23	11301002000673	Hexagon head bolt and plain washer	3		
24	12223000001932	Supporter subassembly of fan motor	3		
25	12223000001992	Supporter of fan motor	1		

26	11002015007643	Brushless DC Motor	1		
27	11301705000106	Hexagon head bolt	1		
28	12200101000029	Fan assembly	1		
29	15500302000006	Attachment-flange connection pipe	1		