



# SUBMITTAL DATA SHEET

## ComfortStar®

|  |  |
|--|--|
| <b>CHT12CD-23</b>  |  |
| Location: _____<br>Engineer: _____<br>Submitted to: _____<br>Submitted by: _____<br>Reference: _____ | Approval: _____<br>Date: _____<br>Construction: _____<br>Unit #: _____<br>Drawing #: _____ |

|                    |   |
|--------------------|---|
| <b>Set Model</b>   |   |
| Indoor unit model  | CHT12CD-23(I)   |
| Outdoor unit model | CHT12CD-23(O)   |
| <b>Certified</b>   |   |
| AHRI               |  |
| ETL                |  |

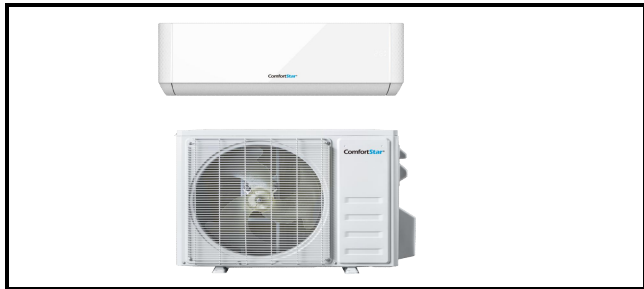

| SYSTEM PERFORMANCE DATA         |            |          |
|---------------------------------|------------|----------|
| Cooling capacity                | Btu/h      | 12000.00 |
| EER2                            | Btu/W.h    | 13.00    |
| SEER2                           | Btu/W.h    | 23.00    |
| Heating capacity(47°F/8.3C)     | Btu/h      | 12000.0  |
| Heating capacity(17°F/-8.3C)    | Btu/h      | 7500.0   |
| Max. Heating capacity(19°F/-7C) | Btu/h      | 10000.0  |
| Heating capacity(5°F/-15C)      | Btu/h      | 9100.0   |
| Rated Input Consumption         | Cooling(W) | 920      |
|                                 | Heating(W) | 910      |
| Rated Current                   | Cooling(A) | 4.1      |
|                                 | Heating(A) | 4.1      |
| Min. Circuit Ampacity           | A          | 11       |
| Maximum Fuse Size               | A          | 15       |

| INDOOR UNIT DATA                  |               |                   |  |
|-----------------------------------|---------------|-------------------|--|
| Unit dimensions                   | mm            | 920×306×195       |  |
| (W x D x H)                       | inch          | 36.22×12.05×7.68  |  |
| Unit net weight                   | kg            | 10.50             |  |
|                                   | lbs           | 23.15             |  |
| Net weight with all accessories   | kg            | 11.50             |  |
|                                   | lbs           | 25.3529           |  |
| Packing dimensions                | mm            | 990×380×265       |  |
| (W x D x H)                       | inch          | 38.98×14.96×10.43 |  |
| Gross weight without pipe         | kg            | 12.00             |  |
|                                   | lbs           | 26.4552           |  |
| Gross weight with all accessories | kg            | 13.50             |  |
|                                   | lbs           | 29.7621           |  |
| <b>Indoor fan motor</b>           |               |                   |  |
| Model                             | ZKFP-20-8-125 |                   |  |
| output                            | W             | 25.0              |  |
| Speed(Hi/Mi/Lo)                   | r/min         | 1250/1050/850/750 |  |
| Indoor air flow (Hi/Mi/Lo)        | m3/h          | 800/650/500       |  |
|                                   | CFM           | 471/382/294       |  |
| Indoor noise level                |               |                   |  |
| (Turbo/High/Med./Low/Mute)        | dB(A)         | 45/39/34/29/27    |  |

| REFRIGERANT PIPE DATA       |                |         |
|-----------------------------|----------------|---------|
| <b>Compressor</b>           |                |         |
| Model                       | KSK103D33UEZC3 |         |
| Type                        | rotary         |         |
| Brand                       | GMCC           |         |
| Capacity                    | W              | 3255.0  |
| Input                       | W              | 830.0   |
| Rated current(RLA)          | A              | 5.7     |
| Refrigerant type            | kg             | 1.2     |
|                             | ozs            | 42.3    |
| Design pressure             | PSIG           | 550.0   |
| <b>Refrigerant piping</b>   |                |         |
| Gas side                    | inch           | 3/8"    |
| Liquid side                 | inch           | 1/4"    |
| Max. refrigerant pipe lengt | (m/ft)         | 15 / 50 |
| Max. difference in level    | (m/ft)         | 10 / 33 |

| OUTDOOR UNIT DATA               |    |      |                   |
|---------------------------------|----|------|-------------------|
| Unit dimensions                 | (W | mm   | 728x305x550       |
| x D x H)                        |    | inch | 28.66x12.01x21.65 |
| Unit net weight                 |    | kg   | 26.8              |
|                                 |    | lbs  | 59.1              |
| Net weight 5m pipe              |    | kg   | 28.8              |
|                                 |    | lbs  | 63.5              |
| Packing dimensions              |    | mm   | 840x340x605       |
| (W x D x H)                     |    | inch | 33.07x13.39x23.82 |
| Gross weight without pipe       |    | kg   | 29.2              |
|                                 |    | lbs  | 64.4              |
| Packing dimensions              |    | mm   | 852x358x610       |
| (W x D x H)                     |    | inch | 33.54x14.09x24.02 |
| Gross weight                    |    | kg   | 31.2              |
| with 5m pipe                    |    | lbs  | 68.8              |
| Packing dimensions              |    | mm   | 860x365x646       |
| (W x D x H)                     |    | inch | 33.86x14.37x25.44 |
| Gross weight                    |    | kg   | 33                |
| with super package with 5m pipe |    | lbs  | 72.8              |

Indoor unit dimension

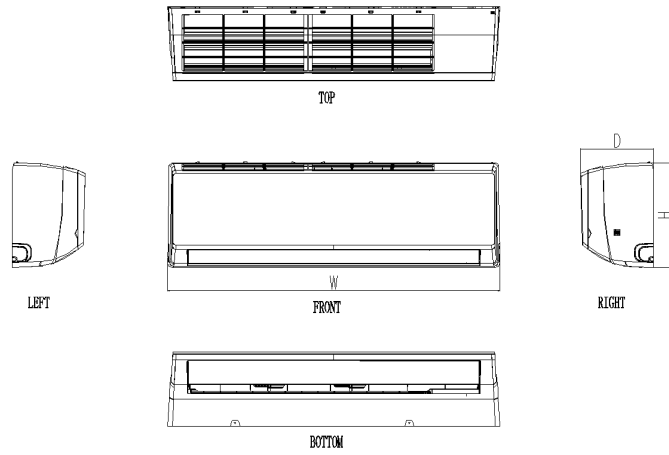

|             | W(mm) | H(mm) | D(mm) |
|-------------|-------|-------|-------|
| 9K/12K (CA) | 820   | 306   | 195   |
| 9K/12K (CD) | 920   | 306   | 195   |
| 18K/24K     | 1100  | 333   | 222   |

Outdoor unit dimension

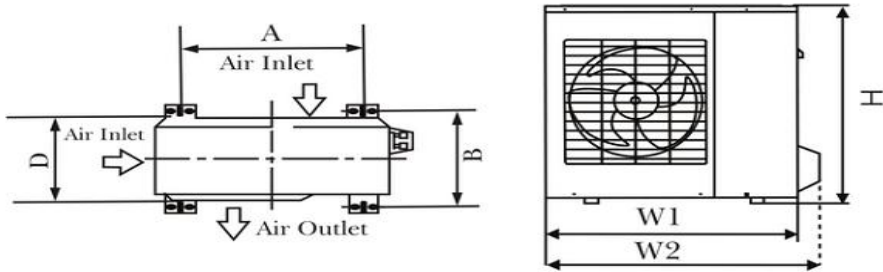

|        | H(mm) | W1(mm) | W2(mm) | D(mm) |
|--------|-------|--------|--------|-------|
| 9K/12K | 549   | 728    | 795    | 256   |
| 18K    | 699   | 845    | 920    | 329   |
| 24K    | 804   | 910    | 967    | 355   |