

Project Name:		Approval:	
Location:		Date:	
Engineer:		Construction:	
Submitted to:		Unit #:	
Submitted by:		Drawing #:	
Reference:			

Sale model	89AC09CD35
------------	------------



### PERFORMANCE DATA

Power supply	V,Hz,Ph	230/208V, 60Hz, 1Ph
--------------	---------	---------------------

#### Cooling

Capacity	Btu/h	9200/9000
Input	W	814/796
Current	A	3.54/3.83
EER	Btu/w	11.3

#### Heating(Heat pump)

Capacity	Btu/h	N/A
Input	W	N/A
Current	A	N/A
COP	W/W	N/A

#### Heating(PTC)

		<b>PTC 1</b>
Capacity	Btu/h	10900/8900
Input	W	3519/2850
Current	A	15.3/13.7
MINIMUM CIRCUIT AMPACITY	A	20

#### Compressor Electrical

Model		PA78G0C-3DZD
Type		Rotary
Brand		GMCC
Capacity	Btu/h	7745/7847.6
Input	W	770/785
Rated current(RLA)	A	3.75/3.5
Locked rotor Amp(LRA)	A	18
Thermal protector		B120-135-141C
Thermal protector position		EXTERNAL
Capacitor	uF	25
Refrigerant oil/oil charge	ml	ESTER OIL VG74.250ML
Connection wiring		12AWGx3 12AWGx3
Plug type		LCDI 6-20P LCDI 6-30P
Thermostat type		Electronic Control

#### SYSTEM DATA

Design pressure	PSIG	540/300
Refrigerant type	oz	R410A/21.16ozs
Application area (Cooling EPA)	sq.ft	350-400
Application area (Cooling Standard)	m2	12-18

### UNIT DIMENSION

Dimension(W*D*H) (without wall sleeve)	inch	42x21x16
Packing (W*D*H)	inch	45.1x25.4x19.3
Net/Gross weight	Kg	45.8/56.9
	lbs.	104.7/130.1
Loading quantity 20' /40' /40'HQ	Pieces	72/144/180

### INDOOR SIDE DATA

Indoor side fan motor		
Model		YDK20-6BS
Brand		Welling
Input		35.5
FLA / OUTPUT	A / Wat	0.155 / 21
Capacitor	uF	1.0
Speed(Hi/Mi/Lo)	r/min	1110/1070/1040
<b>Air flow &amp; Noise level</b>		
Indoor side air flow (Hi/Mi/Lo)	m3/h	740/710/670
Indoor side air flow (Hi/Mi/Lo)	CFM	435/417/394
Indoor side noise level (Hi/Mi/Lo)	dB(A)	50/48/46

### OUTDOOR SIDE DATA

Outdoor side fan motor		
Model		YDK30-4B
Brand		Welling
Input		69
FLA / OUTPUT	A / Wat	0.35 / 37
Capacitor	uF	3.0
Speed	r/min	1400
<b>Air flow &amp; Noise level</b>		
Outdoor side noise level	dB(A)	63

### Operation temperature

Indoor (cooling/ heating)	°C	17-32/0-27
	°F	62°F-90°F/32°F-80°F
Outdoor(cooling/heating)	°C	18-43/-5-24
	°F	64°F-109°F/23°F-76°F

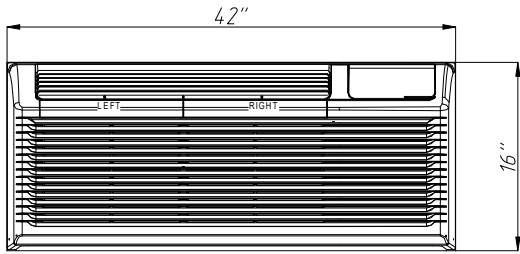

Front View

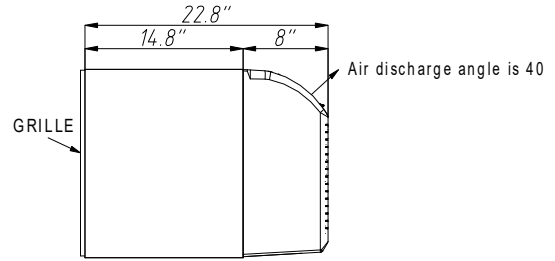

Side View

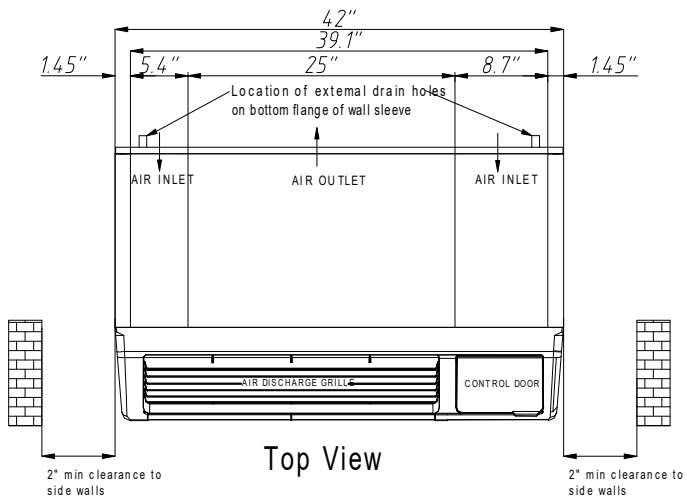

Top View