

Project Name:		Approval:	
Location:		Date:	
Engineer:		Construction:	
Submitted to:		Unit #:	
Submitted by:		Drawing #:	
Reference:			



Sale model	89AC15CD35
------------	------------

PERFORMANCE DATA

Power supply	V,Hz,Ph	230/208V, 60Hz, 1Ph
--------------	---------	---------------------

Cooling

Capacity	Btu/h	14700/14500
Input	W	1547/1526
Current	A	6.73/7.34
EER	Btu/w	9.7

Heating(Heat pump)

Capacity	Btu/h	N/A
Input	W	N/A
Current	A	N/A
COP	W/W	N/A

Heating(PTC)

		PTC 1
Capacity	Btu/h	10900/8900
Input	W	3519/2850
Current	A	15.30/13.70
MINIMUM CIRCUIT AMPACITY	A	20

Compressor Electrical

Model		ASM135N1UEZ
Type		ROTARY
Brand		GMCC
Capacity	Btu/h	13648
Input	W	1310
Rated current(RLA)	A	6.35
Locked rotor Amp(LRA)	A	34.5
Thermal protector		N/A
Thermal protector position		N/A
Capacitor	uF	35
Refrigerant oil/oil charge	ml	SUNISO 4GSD. 350
Connection wiring		12AWGx3 12AWGx3
Plug type		LCDI 6-20P LCDI 6-30P
Thermostat type		Electronic Control

SYSTEM DATA

Design pressure	PSIG	540/300
Refrigerant type	oz	R410A/28.92ozs
Application area (Cooling EPA)	sq.ft	550-700
Application area (Cooling Standard)	m2	20-29

UNIT DIMENSION

Dimension(W*D*H) (without wall sleeve)	inch	42x21x16
Packing (W*D*H)	inch	45.1x25.4x19.3
Net/Gross weight	Kg	51.2/62.3
	lbs.	112.9/137.3
Loading quantity 20' /40' /40'HQ	Pieces	72/144/180

INDOOR SIDE DATA

Indoor side fan motor		
Model		YDK20-6BS
Brand		Welling
Input		35.5
FLA / OUTPUT	A / Wat	0.155 / 21
Capacitor	uF	1.0
Speed(Hi/Mi/Lo)	r/min	1110/1070/1040
Air flow & Noise level		
Indoor side air flow (Hi/Mi/Lo)	m3/h	660/640/620
Indoor side air flow (Hi/Mi/Lo)	CFM	388/376/364
Indoor side noise level (Hi/Mi/Lo)	dB(A)	53/50/45

OUTDOOR SIDE DATA

Outdoor side fan motor		
Model		YDK40-4B
Brand		Welling
Input		87
FLA / OUTPUT	A / Wat	0.41 / 58
Capacitor	uF	3.0
Speed	r/min	1590
Air flow & Noise level		
Outdoor side noise level	dB(A)	66

Operation temperature

Indoor (cooling/ heating)	°C	17-32/0-27
	°F	62°F-90°F/32°F-80°F
Outdoor(cooling/heating)	°C	18-43/-5-24
	°F	64°F-109°F/23°F-76°F

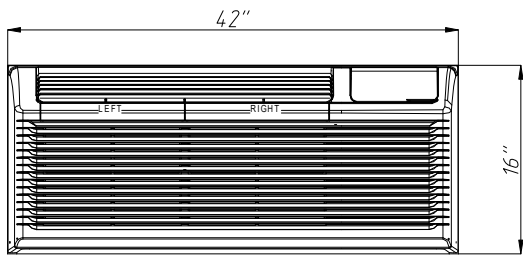

Front View

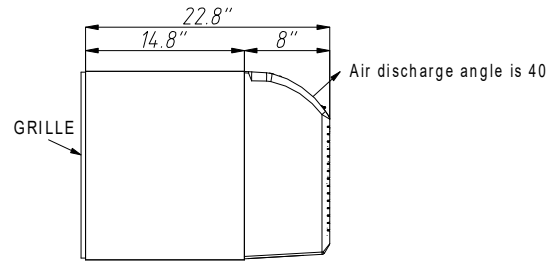

Side View

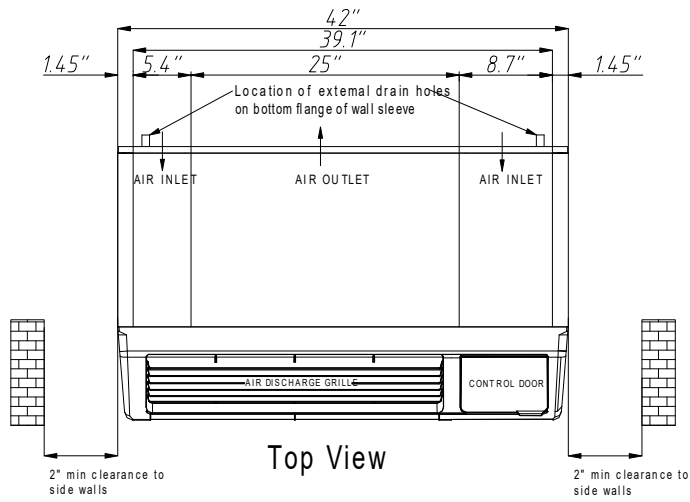

Top View