

Project Name:		Approval:	
Location:		Date:	
Engineer:		Construction:	
Submitted to:		Unit #:	
Submitted by:		Drawing #:	
Reference:			



Sale model	89HP07CD25
------------	------------

PERFORMANCE DATA

Power supply	V,Hz,Ph	230/208V,60Hz
--------------	---------	---------------

Cooling

Capacity	Btu/h	7200/6800
Input	W	610/576
Current	A	2.65/2.76
EER	Btu/w	11.9

Heating(Heat pump)

Capacity	Btu/h	6000/5800
Input	W	517/500
Current	A	2.25/2.41
COP	W/W	3.4

Heating(PTC)

		PTC 1
Capacity	Btu/h	7800/6300
Input	W	2484/2038
Current	A	10.8/9.8
MINIMUM CIRCUIT AMPACITY	A	14

Compressor Electrical

Model		PA58G0C-3DZD
Type		ROTARY
Brand		GMCC
Capacity	Btu/h	5732/5834
Input	W	570/590
Rated current(RLA)	A	2.8/2.65
Locked rotor Amp(LRA)	A	16
Thermal protector		BF520-MA
Thermal protector position		EXTERNAL
Capacitor	uF	20
Refrigerant oil/oil charge	ml	ESTER OIL VG74/250
Connection wiring		14AWGx3 12AWGx3
Plug type		LCDI 6-15P LCDI 6-20P
Thermostat type		Electronic Control

SYSTEM DATA

Design pressure	PSIG	540/300
Refrigerant type	oz	R410A/24.69ozs
Application area (Cooling EPA)	sq.ft	250-300
Application area (Cooling Standard)	m2	10-14

UNIT DIMENSION

Dimension(W*D*H) (without wall sleeve)	inch	42x21x16
Packing (W*D*H)	inch	45.1x25.4x19.3
Net/Gross weight	Kg	46/57.5
	lbs.	101.4/126.8
Loading quantity 20' /40' /40'HQ	Pieces	72/144/180

INDOOR SIDE DATA

Indoor side fan motor		
Model		YDK20-6BS
Brand		Welling
Input		35.5
FLA / OUTPUT	A / Wat	0.155 / 21
Capacitor	uF	1.0
Speed(Hi/Mi/Lo)	r/min	1110/1070/1040
Air flow & Noise level		
Indoor side air flow (Hi/Mi/Lo)	m3/h	730/690/630
Indoor side air flow (Hi/Mi/Lo)	CFM	429/405/370
Indoor side noise level (Hi/Mi/Lo)	dB(A)	50/48/46

OUTDOOR SIDE DATA

Outdoor side fan motor		
Model		YDK30-4B
Brand		Welling
Input		69
FLA / OUTPUT	A / Wat	0.35 / 37
Capacitor	uF	3.0
Speed	r/min	1400
Air flow & Noise level		
Outdoor side noise level	dB(A)	61

Operation temperature

Indoor (cooling/ heating)	°C	17-32/0-27
	°F	62°F-90°F/32°F-80°F
Outdoor(cooling/heating)	°C	18-43/-5-24
	°F	64°F-109°F/23°F-76°F

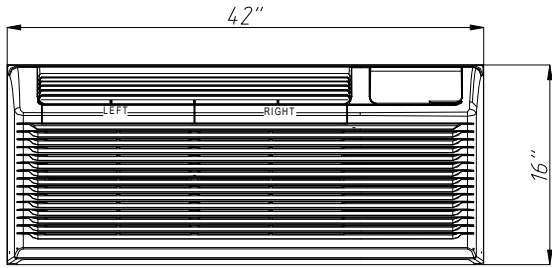

Front View

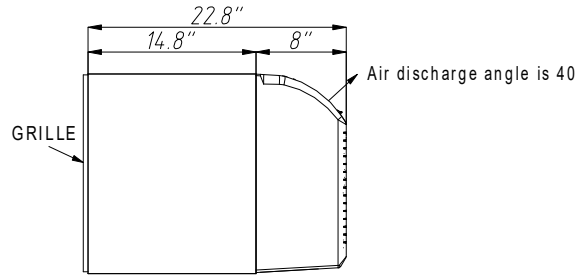

Side View

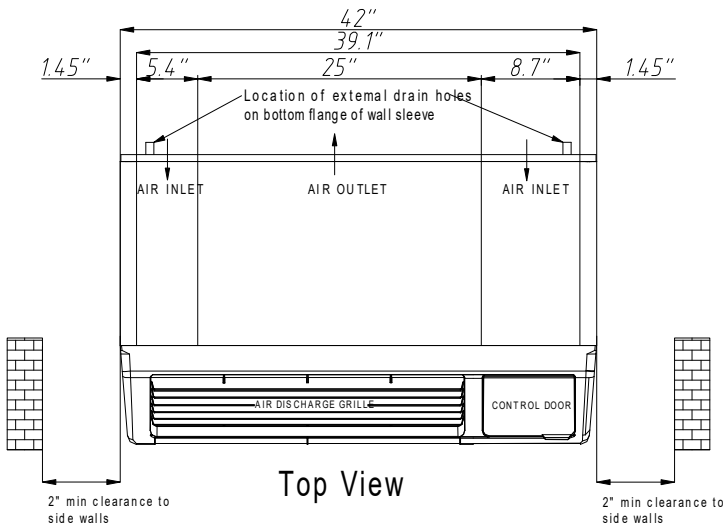

Top View