

Project Name:		Approval:	
Location:		Date:	
Engineer:		Construction:	
Submitted to:		Unit #:	
Submitted by:		Drawing #:	
Reference:			



Sale model	89HP09CD35
------------	------------

PERFORMANCE DATA

Power supply	V,Hz,Ph	230/208V,60Hz
--------------	---------	---------------

Cooling

Capacity	Btu/h	9000/8800
Input	W	796/778
Current	A	3.46/3.75
EER	Btu/w	11.4

Heating(Heat pump)

Capacity	Btu/h	8100/7900
Input	W	716/699
Current	A	3.04/3.28
COP	W/W	3.40

Heating(PTC)

		PTC 1
Capacity	Btu/h	10900/8900
Input	W	3519/2850
Current	A	15.3/13.7
MINIMUM CIRCUIT AMPACITY	A	20

Compressor Electrical

Model		PA78G0C-3DZD
Type		ROTARY
Brand		GMCC
Capacity	Btu/h	7745/7847.6
Input	W	770/785
Rated current(RLA)	A	3.75/3.5
Locked rotor Amp(LRA)	A	18
Thermal protector		B120-135-141C
Thermal protector position		EXTERNAL
Capacitor	uF	25
Refrigerant oil/oil charge	ml	ESTER OIL VG74.250ML
Connection wiring		12AWGx3 12AWGx3
Plug type		LCDI 6-20P LCDI 6-30P
Thermostat type		Electronic Control

SYSTEM DATA

Design pressure	PSIG	540/300
Refrigerant type	oz	R410A/24.69ozs
Application area (Cooling EPA)	sq.ft	350-400
Application area (Cooling Standard)	m2	12-18

UNIT DIMENSION

Dimension(W*D*H) (without wall sleeve)	inch	42x21x16
Packing (W*D*H)	inch	45.1x25.4x19.3
Net/Gross weight	Kg	47.4/58.5
	lbs.	106.9/132.3
Loading quantity 20' /40' /40'HQ	Pieces	72/144/180

INDOOR SIDE DATA

Indoor side fan motor		
Model		YDK20-6BS
Brand		Welling
Input		35.5
FLA / OUTPUT	A / Wat	0.155 / 21
Capacitor	uF	1.0
Speed(Hi/Mi/Lo)	r/min	1110/1070/1040
Air flow & Noise level		
Indoor side air flow (Hi/Mi/Lo)	m3/h	740/710/670
Indoor side air flow (Hi/Mi/Lo)	CFM	435/417/394
Indoor side noise level (Hi/Mi/Lo)	dB(A)	50/48/46

OUTDOOR SIDE DATA

Outdoor side fan motor		
Model		YDK30-4B
Brand		Welling
Input		69
FLA / OUTPUT	A / Wat	0.35 / 37
Capacitor	uF	3.0
Speed	r/min	1400
Air flow & Noise level		
Outdoor side noise level	dB(A)	61

Operation temperature

Indoor (cooling/ heating)	℃	17-32/0-27
	℉	62℉-90℉/32℉-80℉
Outdoor(cooling/heating)	℃	18-43/-5-24
	℉	64℉-109℉/23℉-76℉

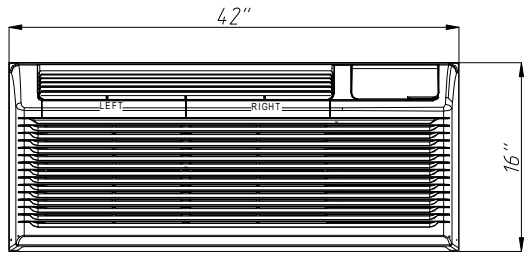

Front View

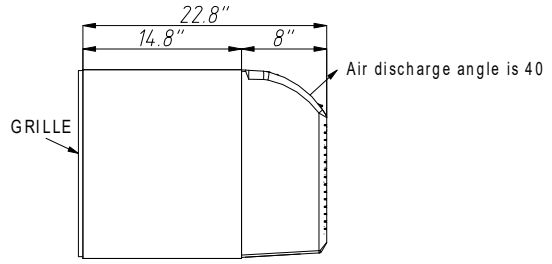

Side View

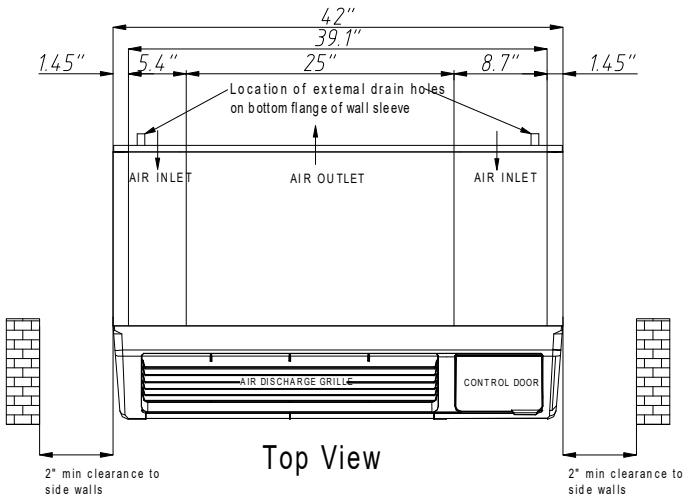

Top View