

Project Name:		Approval:	
Location:		Date:	
Engineer:		Construction:	
Submitted to:		Unit #:	
Submitted by:		Drawing #:	
Reference:			

Sale model	89HP12CD35
------------	------------



### PERFORMANCE DATA

Power supply	V,Hz,Ph	230/208V,60Hz
--------------	---------	---------------

#### Cooling

Capacity	Btu/h	12000/11800
Input	W	1142/1124
Current	A	4.97/5.4
EER	Btu/w	10.5

#### Heating(Heat pump)

Capacity	Btu/h	10800/10500
Input	W	990/963
Current	A	4.3/4.63
COP	W/W	3.20

#### Heating(PTC)

		PTC 1
Capacity	Btu/h	10900/8900
Input	W	3519/2850
Current	A	15.3/13.7
MINIMUM CIRCUIT AMPACITY	A	20

#### Compressor Electrical

Model		PA108M1C-3FZDU
Type		ROTARY
Brand		GMCC
Capacity	Btu/h	10714/10850
Input	W	1045/1050
Rated current(RLA)	A	5.0/4.55
Locked rotor Amp(LRA)	A	25.9
Thermal protector		B185-135-141C
Thermal protector position		EXTERNAL
Capacitor	uF	35
Refrigerant oil/oil charge	ml	ESTEL OIL VG74.350ml
Connection wiring		12AWGx3 12AWGx3
Plug type		LCDI 6-20P LCDI 6-30P
Thermostat type		Electronic Control

#### SYSTEM DATA

Design pressure	PSIG	540/300
Refrigerant type	oz	R410A/31.39ozs
Application area (Cooling EPA)	sq.ft	450-500
Application area (Cooling Standard)	m2	16-23

### UNIT DIMENSION

Dimension(W*D*H) (without wall sleeve)	inch	42x21x16
Packing (W*D*H)	inch	45.1x25.4x19.3
Net/Gross weight	Kg	52.5/63.6
	lbs.	115.7/140.2
Loading quantity 20' /40' /40'HQ	Pieces	72/144/180

### INDOOR SIDE DATA

Indoor side fan motor		
Model		YDK20-6BS
Brand		Welling
Input		35.5
FLA / OUTPUT	A / Wat	0.155 / 21
Capacitor	uF	1.0
Speed(Hi/Mi/Lo)	r/min	1110/1070/1040
<b>Air flow &amp; Noise level</b>		
Indoor side air flow (Hi/Mi/Lo)	m3/h	740/720/700
Indoor side air flow (Hi/Mi/Lo)	CFM	435/423/411
Indoor side noise level (Hi/Mi/Lo)	dB(A)	53/50/45

### OUTDOOR SIDE DATA

Outdoor side fan motor		
Model		YDK40-4B
Brand		Welling
Input		87
FLA / OUTPUT	A / Wat	0.41 / 58
Capacitor	uF	3.0
Speed	r/min	1590
<b>Air flow &amp; Noise level</b>		
Outdoor side noise level	dB(A)	66

### Operation temperature

Indoor (cooling/ heating)	°C	17-32/0-27
	°F	62°F-90°F/32°F-80°F
Outdoor(cooling/heating)	°C	18-43/-5-24
	°F	64°F-109°F/23°F-76°F

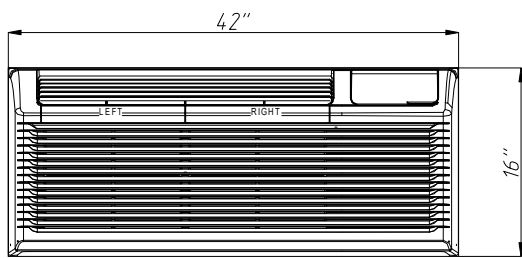

Front View

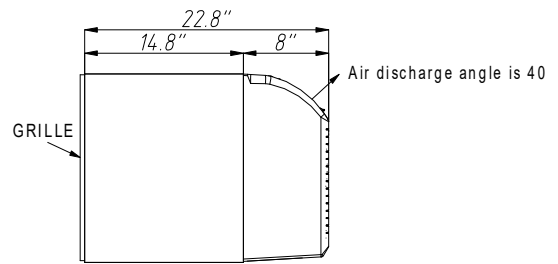

Side View

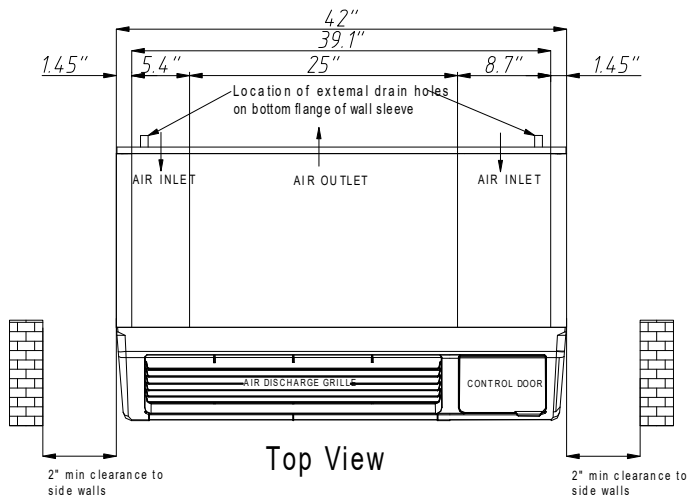

Top View