

Exploded View

Model CFU12CA(I)

ComfortStar®

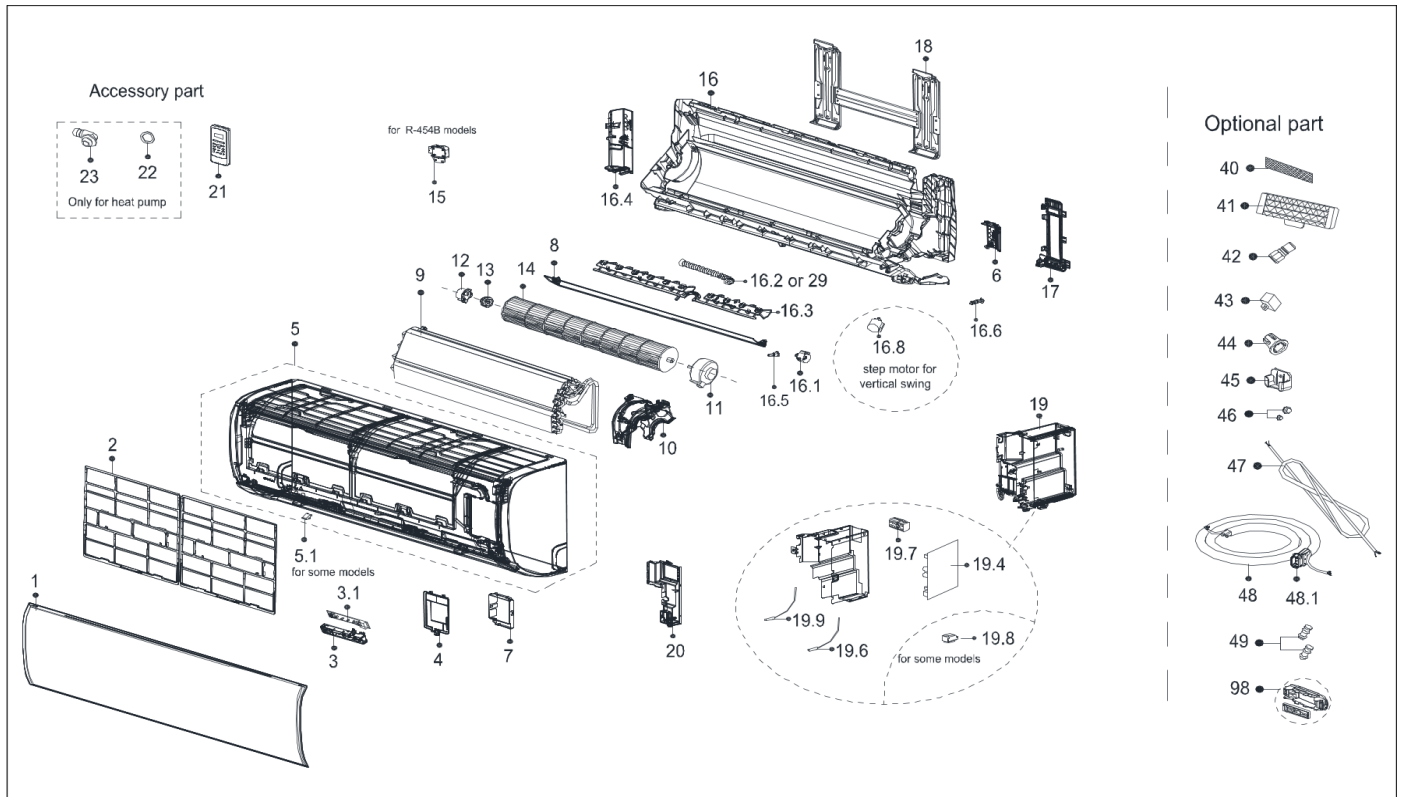

EX_ID	Spare Parts Code	Part Name(EN)	Qty.	Price	Remarks
1	12122000A88533	Panel assembly	1.00		
1	12122000A88533	Panel assembly	1.00		
2	12122000015224	Filter	2.00		
2	12122000015224	Filter	2.00		
3	17222000A18768	Display Box Subassembly	1.00		
3	17222000A18768	Display Box Subassembly	1.00		
3.1	17122000041912	Display board subassembly	1.00		
3.1	17122000041912	Display board subassembly	1.00		
4	12122000013131	Cover Plate	1.00		

4	12122000013131	Cover Plate	1.00		
5	12122000013170	Panel Frame Assembly	1.00		
5	12122000013170	Panel Frame Assembly	1.00		
5.1	12122000013139	Screw Cap	2.00		
5.1	12122000013139	Screw Cap	2.00		
6	12122000013140	Front Cover of Chassis(Right)	1.00		
6	12122000013140	Front Cover of Chassis(Right)	1.00		
7	12122000013141	Cover of Electrical Equipment Subassembly	1.00		
7	12122000013141	Cover of Electrical Equipment Subassembly	1.00		
8	12122000013168	Louver Subassembly	1.00		
8	12122000013168	Louver Subassembly	1.00		
9	15822000008180	Evaporator Assembly	1.00		
9	15822000008180	Evaporator Assembly	1.00		
10	12122000013129	Motor Cover	1.00		
10	12122000013129	Motor Cover	1.00		
11	11002012005527	Single Phase Asynchronous Motor	1.00		
11	11002012005527	Single Phase Asynchronous Motor	1.00		
12	12122000000350	Bearing Sleeve	1.00		
12	12122000000350	Bearing Sleeve	1.00		
13	12622000000131	Bearing Block Assembly	1.00		
13	12622000000131	Bearing Block Assembly	1.00		
14	12100102000044	Cross Flow Fan	1.00		
14	12100102000044	Cross Flow Fan	1.00		
16	12122000013163	Chassis Assembly	1.00		
16	12122000013163	Chassis Assembly	1.00		
16.1	11002010000143	Stepper Motor	1.00		
16.1	11002010000143	Stepper Motor	1.00		
16.2	12100501000032	Drain Hose	1.00		
16.2	12100501000032	Drain Hose	1.00		
16.3	12122000013167	Horizontal Louver	1.00		
16.3	12122000013167	Horizontal Louver	1.00		
16.4	12122000013123	Front Cover of Chassis(Left)	1.00		
16.4	12122000013123	Front Cover of Chassis(Left)	1.00		

16.5	12122000000344	Electricity Preventing Axis	1.00		
16.5	12122000000344	Electricity Preventing Axis	1.00		
16.6	12622000000030	Drainage plug	1.00		
16.6	12622000000030	Drainage plug	1.00		
17	12122000013136	pipe clamp board	1.00		
17	12122000013136	pipe clamp board	1.00		
18	12222000005844	Installation Plate	1.00		
18	12222000005844	Installation Plate	1.00		
19	17222000043037	Electronic control box subassembly (Mid-and low-end)	1.00		
19	17222000043037	Electronic control box subassembly (Mid-and low-end)	1.00		
19.4	17122000062545	Main control board subassembly	1.00		
19.4	17122000062545	Main control board subassembly	1.00		
19.6	11201007003447	Pipe Temperature Sensor	1.00		
19.6	11201007003447	Pipe Temperature Sensor	1.00		
19.7	17400401000094	Terminal	1.00		
19.7	17400401000094	Terminal	1.00		
19.9	11201007003424	Room Temperature Sensor	1.00		
19.9	11201007003424	Room Temperature Sensor	1.00		
20	12122000013132	Electrical Control Box Cover Subassembly	1.00		
20	12122000013132	Electrical Control Box Cover Subassembly	1.00		
21	17317000A65321	Remote controller	1.00		
21	17317000A65321	Remote controller	1.00		
40	12100204000685	Cold Catalyst Air Filter	1.00		
40	12100204000685	Cold Catalyst Air Filter	1.00		
45	12122000029201	Bracket of Remote Controller	1.00		
45	12122000029201	Bracket of Remote Controller	1.00		
47	17401203A00145	Indoor and Outdoor Junction Cable	1.00		
47	17401203A00145	Indoor and Outdoor Junction Cable	1.00		