

# ComfortStar®

Air Conditioning & Heating Products

## CARAT II

### REMOTE CONTROL

## OWNER'S MANUAL

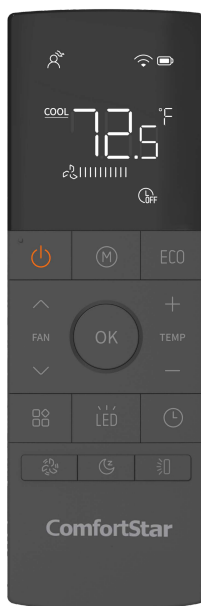

#### IMPORTANT NOTE:

Thank you for purchasing our air conditioner. Please read this manual carefully before operating your new air conditioning unit. Make sure to save this manual for future reference.



# CONTENTS

Remote Controller Specifications .....02

Handling the Remote Controller .....03

Buttons and Functions .....04

Remote Screen Indicators .....05

How to Use Basic Functions .....06

How to Use Advanced Functions .....09

# Remote Controller Specifications

<b>Model</b>	RG081AE1(2S)/BGEF, RG081AE1(2S)/BGEFL
<b>Rated Voltage</b>	3.0V ( Dry batteries R03/LR03×2)
<b>Signal Receiving Range</b>	8m
<b>Environment</b>	-5°C-60°C (23°F-140°F)

## Quick Start Guide

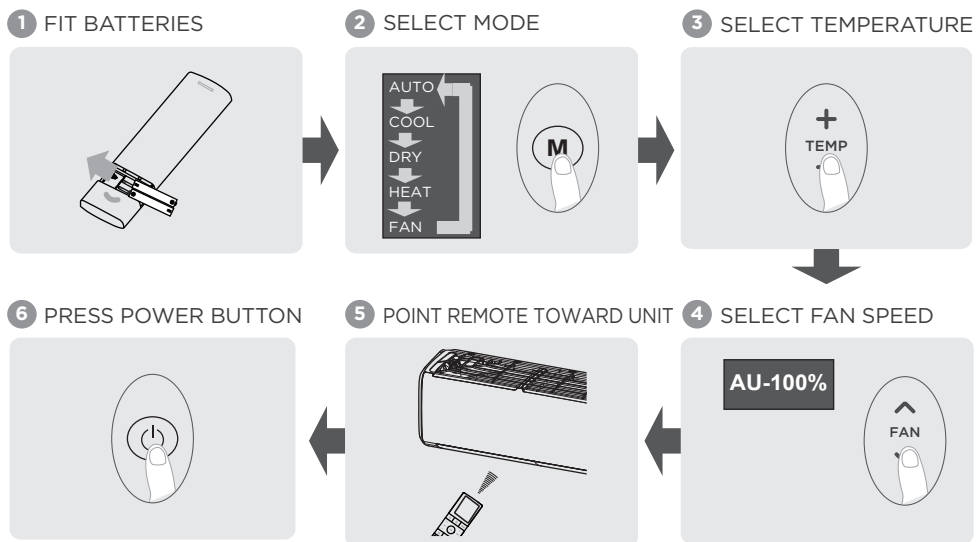

## NOT SURE WHAT A FUNCTION DOES?

Refer to the How to Use Basic Functions and How to Use Advanced Functions sections of this manual for a detailed description of how to use your air conditioner.

## SPECIAL NOTE

- Button designs on your unit may differ slightly from the example shown.
- If the indoor unit does not have a particular function, pressing the corresponding button on the remote control will have no effect.
- When there are wide differences between “Remote controller Manual” and “USER’S MANUAL” on function description, the description of “USER’S MANUAL” shall prevail.

# Handling the Remote Controller

## Inserting and Replacing Batteries

The remote control requires 2 batteries. These may or may not be provided with your model. Put the batteries in the remote control before use.

1. Slide the back cover of the remote control downward, exposing the battery compartment.
2. Insert the batteries, paying attention to matching up the (+) and (-) ends of the batteries with the symbols inside the battery compartment.
3. Slide the battery cover back into place.

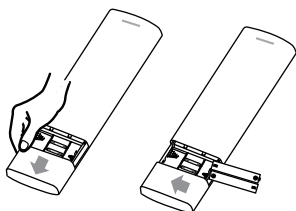

## Remote Control

- Direct sunlight can interfere with the infrared signal receiver.
- There must be a clear line of sight between the remote and the appliance.
- If the signals from the remote control happen to control another appliance, move the appliance to another location or contact customer service.

## ! Battery Disposal

- Do not dispose of batteries as unsorted municipal waste. Refer to local laws for proper disposal of batteries.
- Batteries may have a chemical symbol under the disposal icon. This chemical symbol means that the battery contains a heavy metal that exceeds a certain concentration.  
An example is Pb: Lead (>0.004%).
- Appliances and used batteries must be treated in a specialized facility for reuse, recycling and recovery. By ensuring correct disposal, you will help avoid possible negative consequences for the environment and human health.



## Battery Performance

For optimal product performance:

- Do not mix old and new batteries, or batteries of different brands.
- Do not leave batteries in the remote control if you don't plan on using the device for more than 2 months.

## Notes for Using Remote Control

The device could comply with the local national regulations.

- In Canada, it should comply with CAN ICES-3(B)/NMB-3(B).
- In the USA, this device complies with part 15 of the FCC Rules. Operation is subject to the following two conditions:
  - (1) This device may not cause harmful interference, and
  - (2) This device must accept any interference received, including interference that may cause undesired operation.

This equipment has been tested and found to comply with the limits for a Class B digital device, pursuant to part 15 of the FCC Rules.

These limits are designed to provide reasonable protection against harmful interference in a residential installation. This equipment generates, uses and can radiate radio frequency energy and, if not installed and used in accordance with the instructions, may cause harmful interference to radio communications. However, there is no guarantee that interference will not occur in a particular installation. If this equipment does cause harmful interference to radio or television reception, which can be determined by turning the equipment off and on, the user is encouraged to try to correct the interference by one or more of the following measures:

- Reorient or relocate the receiving antenna.
- Increase the separation between the equipment and receiver.
- Connect the equipment into an outlet on a circuit different from that to which the receiver is connected.
- Consult the dealer or an experienced radio/TV technician for help.
- Changes or modifications not approved by the party responsible for compliance could void user's authority to operate the equipment.

## Buttons and Functions

Before you begin using your new air conditioner, make sure to familiarize yourself with the remote controller. The following content is a brief introduction of the remote controller. For instructions on how to operate your air conditioner, refer to this manual of How to Use Basic Functions section.

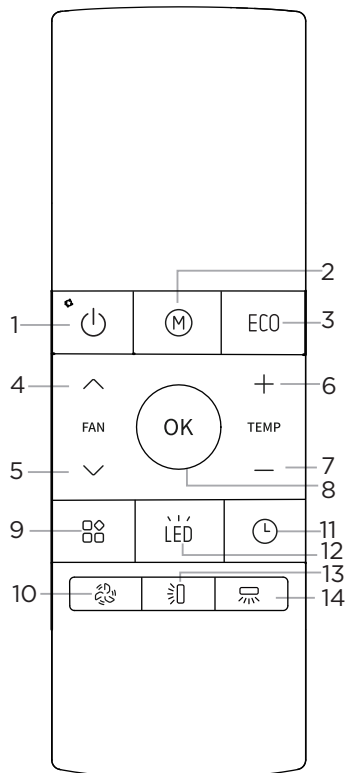

**Model:**  
RG081AE1(2S)/BGEF  
(Fresh/UV lamp feature is not available)

RG081AE1(2S)/BGEFL

### Description

- 1 ON/OFF:** Turn the unit on or off.
- 2 Mode:** Auto > Cool > Dry > Heat > Fan  
**Note:** Auto and Heat mode are not available for the cooling only appliance.
- 3 ECO:** Starts and stops the ECO operation.
- 4 FAN Speed ^:** AU > 20% > 40% > 60% > 80% > 100%. Press the TEMP + or - button to increase/decrease the fan speed in 1% increments.
- 5 FAN Speed v:** AU > 100% > 80% > 60% > 40% > 20%. Press the TEMP + or - button to increase/decrease the fan speed in 1% increments.
- 6 TEMP Up +:** Increases temperature in 1°C (1°F) increments. Max. temperature is 30°C (86°F).  
**NOTE:** Press + & - buttons at the same time for 3 seconds will alternate the temperature display between the °C & °F
- 7 TEMP Down -:** Decreases temperature in 1°C (1°F) increments. Min. temperature is 16°C (60°F).
- 8 OK:** Used to confirm the selected functions  
**SET:** Intelligent humidity control > Sleep > Fresh/UV lamp\* > Breeze Away > Follow Me > Active Clean > AP mode\*  
**Note:** Every time you press the button, the function will switch to the next one. When the desired function is displayed, you can press the OK button to confirm, or wait for 5 seconds for the function to start automatically.  
[\*]: Model dependent
- 9 Turbo:** Reduce (cool mode) or raise (heat mode) temperature in a short time.
- 10 Timer:** Set timer to turn unit on or off.
- 11 LED:** Turns LED display & air conditioner buzzer on and off.
- 12 Swing (up and down):** Starts and stops the horizontal louver movement.
- 13 Swing (left and right):** Starts and stops the vertical louver movement.

## Remote Screen Indicators

Information is displayed when the remote controller is power up.

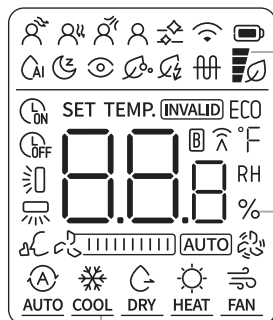

Breeze away people   
 Not available for this unit.   
 Follow me   
 Active clean   
 Wireless\* control   
 Low battery (If flashes)

Intelligent humidity control   
 Sleep mode   
 Intelligent eye\*   
 Fresh\*   
 Gear mode\*   
 Not available for this unit.

[\*]: Model dependent

**Temperature/Timer/Fan speed display**  
 Displays the set temperature by default, fan speed, or Timer setting when using Timer on/off functions.

### FAN SPEED

#### AUTO

<b>AUTO</b>	I	II	III	IIII	IIIII
	1-10%	11-20%	21-30%	31-40%	41-50%
	IIIIIII	IIIIIIIII	IIIIIIIIIII	IIIIIIIIIIIII	IIIIIIIIIIIIIII
	51-60%	61-70%	71-80%	81-90%	91-100%

**Note:** The fan speed can not be adjusted in AUTO or DRY mode.

	<b>ECO</b>				<b>INVALID</b>
Transmission Indicator	ECO feature	Silent feature	Turbo feature	Not available for this unit.	Displayed when the operation is invalid.
Timer ON	Timer OFF	Horizontal louver swing		Vertical louver auto swing	

**MODE display:** Displays the current mode

**AUTO**   
 **COOL**   
 **DRY**   
 **HEAT**   
 **FAN**

AUTO and HEAT mode are for cooling and heating models only.

**Note:** While using the remote controller, only relevant function indicator will be shown. The indicators above are for reference only.

# How to Use Basic Functions



## NOTE

Before operation, please ensure that the unit is plugged in and the power is available.

### AUTO mode

Select AUTO mode

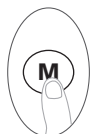

Set your desired temperature



Turn on the air conditioner



#### Note:

1. In AUTO mode, the unit will automatically select the COOL, FAN, or HEAT function based on the selected temperature.
2. In AUTO mode, fan speed cannot be set.

### COOL or HEAT mode

Select COOL/HEAT mode

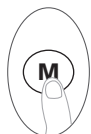

Set the temperature



Set the FAN speed



Turn on the air conditioner



**Note:** Heat mode is only applicable to the Cooling & Heating models only.

### DRY mode

Select DRY mode

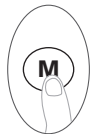

Set your desired temperature



Turn on the air conditioner



**Note:** In DRY mode, fan speed cannot be set since it has already been automatically controlled.

### FAN mode

Select FAN mode

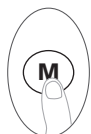

Set the FAN speed



Turn on the air conditioner



**Note:** In FAN mode, you can't set the temperature. As a result, no temperature is displayed on the remote's screen.



## Setting the TIMER

**TIMER ON/OFF** - Set the amount of time after which the unit will automatically turn on/off.

### TIMER ON setting

Press TIMER button to initiate the time ON sequence.

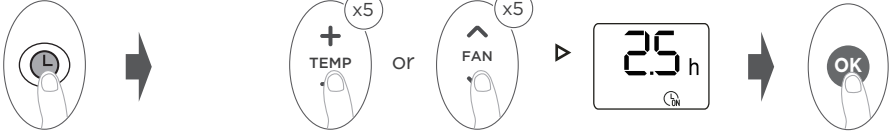

Press TEMP “+” or “-” or FAN “^” or “v” button to set the length of time after which you would like the unit to turn ON. Press the OK button to activate time to turn on the unit.

### TIMER OFF setting

Press TIMER button to initiate the time OFF sequence.

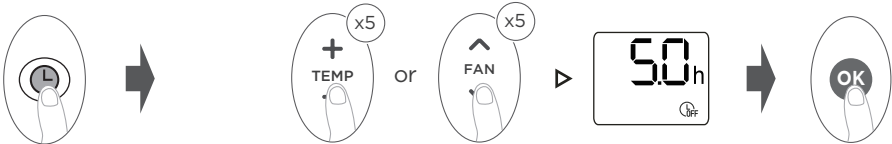

Press TEMP “+” or “-” or FAN “^” or “v” button to set the length of time after which you would like the unit to turn OFF. Press the OK button to activate time to turn off the unit.

### Note:

1. When setting the TIMER ON or TIMER OFF, the time will increase in 30-minute increments with each press, up to 10 hours. After 10 hours and up to 24:00, it will increase in 1-hour increments (For example, press 5 times to get 2.5h and press 10 times to get 5h). The timer will revert to 0:00 after 24:00.
2. Cancel either function by setting the timer to 0:00h.

### TIMER ON & OFF setting (example)

Keep in mind that the time periods you set for both functions refer to hours after the current time.

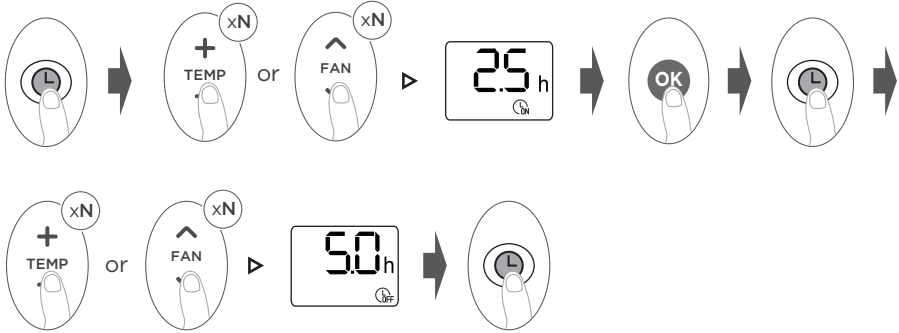

**Note:** " x N " means you can press multiple times until it is set to the time you need.

**Example:** If current time is 1:00 PM, after setting the timer as above steps, the unit will turn on 2.5h later (3:30 PM) and turn off at 6:00 PM.

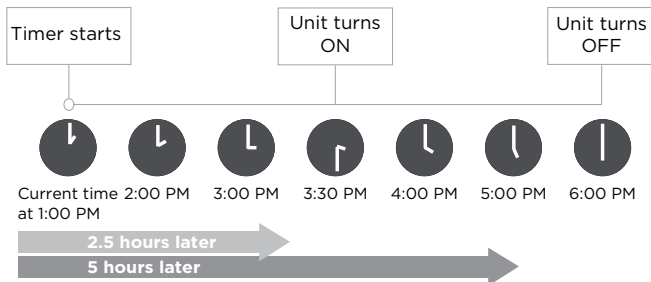

# How to Use Advanced Functions

## Swing function

Press Swing up and down button

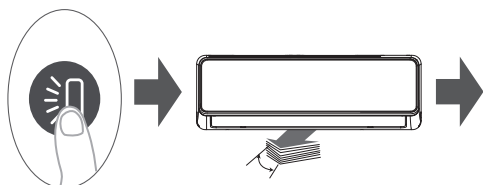

Press this button repeatedly, and if the interval between presses is within 3 seconds, the horizontal louver will operate in the following order:  
Louver auto swing stop > Louver auto swing start > Louver angle 1 > Louver angle 2 > Louver angle 3 > Louver angle 4 > Louver angle 5.

Press this button repeatedly, and if the interval between presses is more than 3 seconds, the horizontal louver will operate in the following order:  
Louver at a certain angle > Louver auto swing start > Louver auto swing stop.

Press Swing left and right button

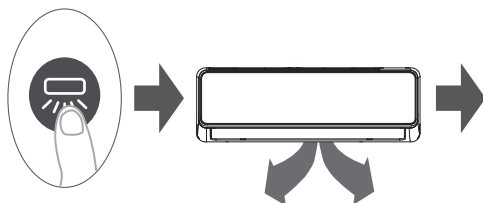

Press this button repeatedly, and if the interval between presses is within 3 seconds, the vertical louver will operate in the following order:  
Louver auto swing stop > Louver auto swing start > Louver angle 1 > Louver angle 2 > Louver angle 3 > Louver angle 4 > Louver angle 5.

Press this button repeatedly, and if the interval between presses is more than 3 seconds, the vertical louver will operate in the following order:  
Louver at a certain angle > Louver auto swing start > Louver auto swing stop.

## Silent function



Keep pressing Fan button for more than 2 seconds to activate/disable the Silent function (some units).

Due to low frequency operation of compressor, it may result in insufficient cooling and heating capacity.

## FP function



The unit will operate at high fan speed (while compressor is on) with temperature automatically set to 8°C/46°F.

Note: This function is for heat pump air conditioner only.

Press this button 2 times during one second under HEAT mode with setting temperature of 16°C/60°F to activate FP function. The indoor unit will display "FP" on the display window. Press On/Off, Mode, FAN and Temp. button while operating will cancel this function.

## LED display



Press this button to turn on and turn off the display on the indoor unit.



Press this button for more than 5 seconds (some units)

After keeping pressing this button for more than 5 seconds, the indoor unit will display the actual room temperature. Pressing the button for more than 5 seconds again will revert back to display the setting temperature.

## ECO function

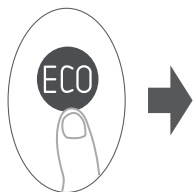

Press this button when in Cool/Heat mode, the fan speed will change to Auto, the set temperature will remain unchanged which brings more comfortable feelings and power-saving, and reduces temperature fluctuations.

**NOTE:** This function is only available when the unit is in Cool or Heat mode. The Turbo and Silent function will be cancel when the ECO function is activated. Initiating the Active clean, Turbo, FP, Silent function or pressing the Mode or ON/OFF button will cancel the ECO function.

## Turbo function

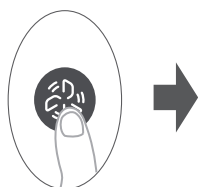

When you select Turbo feature in COOL mode, the unit will blow cool air with strongest wind setting to jump-start the cooling process.

When you select Turbo feature in HEAT mode, the unit will blow heat air with strongest wind setting to jump-start the heating process (some units).

For units with Electric heat elements, the Electric HEATER will activate and jump-start the heating process.

## Louver reset function (some units)

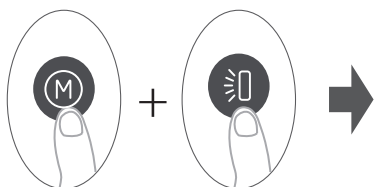

Turn off system from remote control and then press "Mode" and "Swing" button together until hear beep sound from indoor. The indoor is into louver re-set mode. Do not press any button and it is completing the process automatically.

## SET function



- Press the SET button to enter the function setting, then press SET button to select the desired function. The selected symbol will flash on the display area, press the OK button to confirm.
- To cancel the selected function, just perform the same procedures as above.
- Press the SET button to scroll through operation functions as follows:

Intelligent humidity control ( ) > Sleep ( ) > Fresh /UV lamp\* ( ) >  
 Breeze away ( ) > Follow Me ( ) > Active clean ( ) > AP mode\* ( )  
 [ \* ]: Model dependent.

### Intelligent Humidity Control Function

Initiate this function when in Cool mode, the fan speed will change to Auto, the set temperature will remain unchanged. The system can control the room humidity to ensure that it is not too dry or too damp while maintaining a comfortable temperature.

NOTE: This function is only available when the unit is in Cool mode.

When the Intelligent Humidity Control function is activated, the Turbo, Silent, ECO or Clean function will automatically exit if it is enabled on the machine.

When turning the unit off or initiating the Clean or ECO function, the Intelligent Humidity Control function will automatically exit.

### Sleep Function

Use this feature to create a more comfortable sleeping environment. When the sleep function is activated, the air conditioner will intelligently adjust temperature, fan speed to provide a more comfortable sleeping environment. Under sleep operation, the system will automatically remember the set temperature within 30 minutes. The next time it is activated, it will start running at the temperature of the last memory. After the sleep function is activated, it will automatically be cancelled after 9 hours.

### **Fresh/UV Lamp Function (some units)**

When the Fresh function is initiated, the Ionizer or UV-C lamp (model dependent) feature will be activated. If the unit has both features, these two features will be activated at the same time and will help to purify the air in the room.

### **Breeze Away Function**

Use this feature to avoid direct air flow blowing on the body and makes you feel indulging in silky coolness.

### **Follow Me Function**

The FOLLOW ME function enables the remote control to measure the temperature at its current location and send this signal to the air conditioner in 3 minute intervals. When using AUTO, COOL or HEAT modes, measuring ambient temperature from the remote control (instead of from the indoor unit itself) will enable the air conditioner to optimize the temperature around you and ensure maximum comfort.

**NOTE:** Press and hold Turbo button for 7 seconds to start/stop the memory feature of the Follow Me function.

- If the memory feature is activated, “ On ” displays for 3 seconds on the screen.
- If the memory feature is stopped, “ OF ” displays for 3 seconds on the screen.
- While the memory feature is activated, pressing the ON/OFF button, shifting the mode or a power failure will not cancel the Follow Me function.

### **Active Clean Function**

The Active Clean technology removes dust and mold that may cause odors. Active Clean rapidly freezes and thaws the heat exchanger, to clean away material that has adhered to it. When this function is turned on, the indoor unit displays “ CL ”. After 20 to 130 minutes, the unit will turn off automatically and terminate CLEAN function.

### **AP Function (some units)**

Use the SET button to choose AP (Access Point) mode to enable wireless configuration. If this function is not available on this unit, it might be possible to enter AP mode by pressing the LED button 7 times in 10 seconds.

The design and specifications are subject to change without prior notice for product improvement. Consult with the sales agency or manufacturer for details.

**CR368-RG081AE1(2S)**