

Exploded View

ComfortStar®

Model CDP7-60-15 (30V)
Service code: 30V

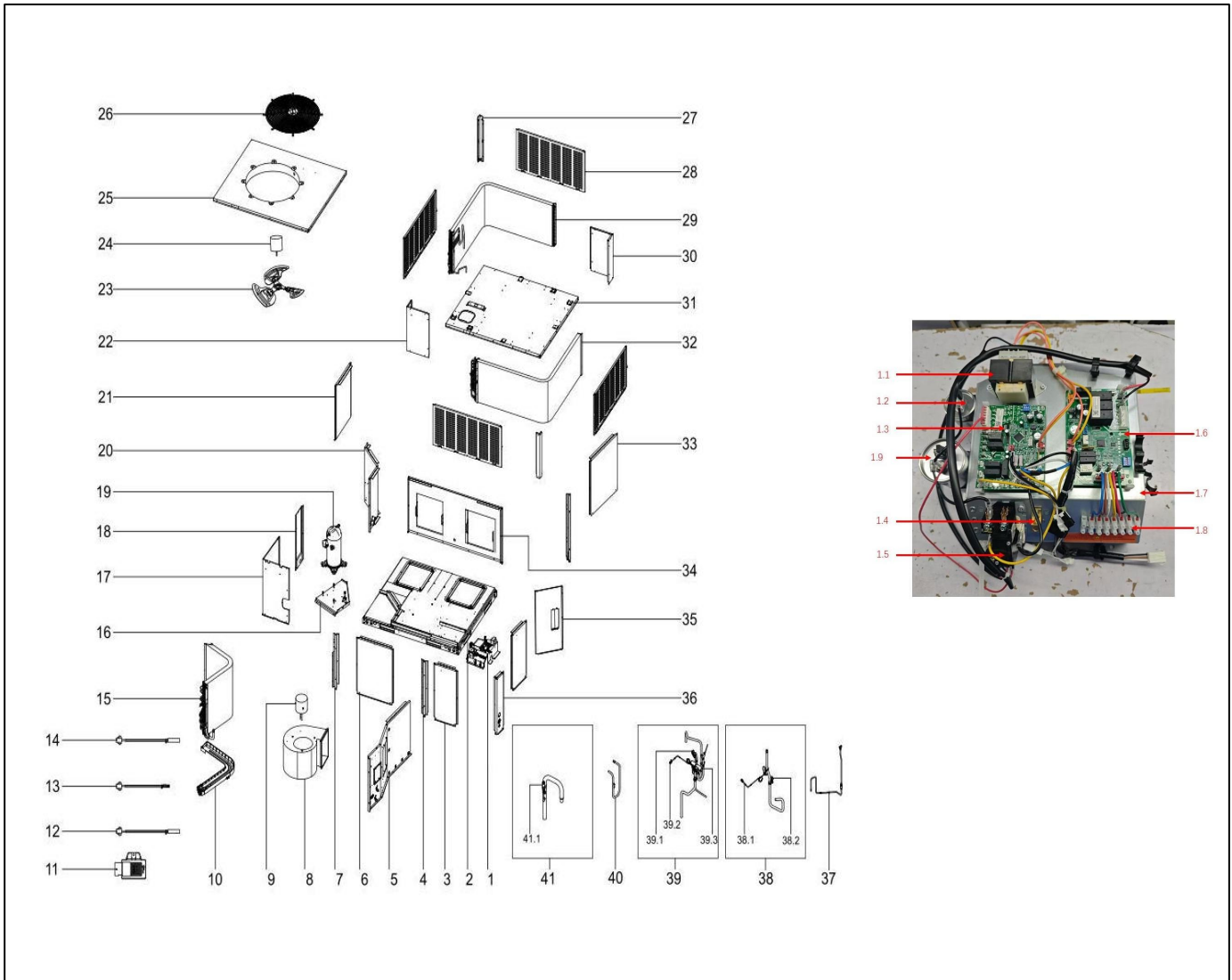

EX_ID	Spare Parts Code	Part Name(EN)	Qty.	Price	Remarks
1	17227700001580	E-part box assembly	1.0		
1.1	11203103000194	Linear Transformer	1.0		
1.2	17400103000151	Compressor Capacitor	1.0		

1.3	17127700001468	Main Control Board Assembly	1.0		
1.4	11201708000008	Terminal	1.0		
1.5	11203502000032	AC Contactor	1.0		
1.6	17123000012124	Indoor unit main control board	1.0		
1.7	12227700011985	Electrical appliance mounting plate assembly	1.0		
1.8	17400401000196	Wire Joint	1.0		
1.9	17400103000133	Compressor Capacitor	1.0		
2	12227700A09629	Chassis part	1.0		
3	12227700A07841	components inside the panel	2.0		
4	12227700010481	Column assembly	2.0		
5	12227700011715	Partition board assembly	1.0		
6	12227700006366	components inside the panel	1.0		
7	12227700A09392	Column	1.0		
8	12200101000213	Wind Turbine Parts	1.0		
9	11002015023011	Brushless DC Motor	1.0		
10	12127700000277	Drain Pan Assembly	1.0		
11	11201003000424	Gas sensor	1.0		R454B sensor
12	17400513000070	Discharge Temperature switch	1.0		T5
13	11201007000412	Pipe Temperature Sensor	1.0		T3
14	11201007000025	Room Temperature Sensor	1.0		T4
15	15827700001189	Evaporator Assembly	1.0		
16	12227700006414	Compressor base	1.0		
17	12227700A09389	Side Panel	1.0		
18	12227700006361	Column assembly	1.0		
19	11102010002238	Fixed Speed Scroll Compressor	1.0		
20	12227700006360	Partition board assembly	1.0		
21	12227700006371	components inside the panel	1.0		
22	12227700A09627	Column assembly	1.0		
23	12200104000122	Axial Flow Fan	1.0		
24	11002012028483	Single Phase Asynchronous Motor	1.0		
25	12227700010180	Top cover welding assembly	1.0		
26	12927700000301	Grille	1.0		
27	12227700006368	Column	2.0		
28	12227700A09626	Protective Plate Assembly	4.0		

29	15827700001450	Condenser Assembly	1.0		
30	12227700A09628	Column	1.0		
31	12227700A07782	Top cover assembly	1.0		
32	15827700000708	Condenser Assembly	1.0		
33	12227700006370	components inside the panel	1.0		
34	12227700006363	components inside the panel	1.0		
35	12227700012304	Air Duct Assembly	1.0		
36	12227700A07848	Column assembly	1.0		
37	15427700002619	Piston Throttling Valve Assembly	1.0		
38	15427700002630	Suction Pipe Assembly	1.0		
38.1	15127700007354	Schrader Valve	1.0		
38.2	17400516001509	Low Pressure Controller	1.0		
39	15427700002650	Four-Way Valve Assembly	1.0		
39.1	17400516001508	High Pressure Controller	1.0		
39.2	15500301000035	Schrader Valve	1.0		
39.3	15500216003143	Four-Way Valve	1.0		
40	15427700002629	Air discharge pipe assembly	1.0		
41	15427700002670	Suction Pipe Assembly	1.0		
41.1	15427000007112	Fusible Plug Assembly	1.0		