

Exploded View

ComfortStar®

Model CPH7-36-15 (30N)
Service code: 30N

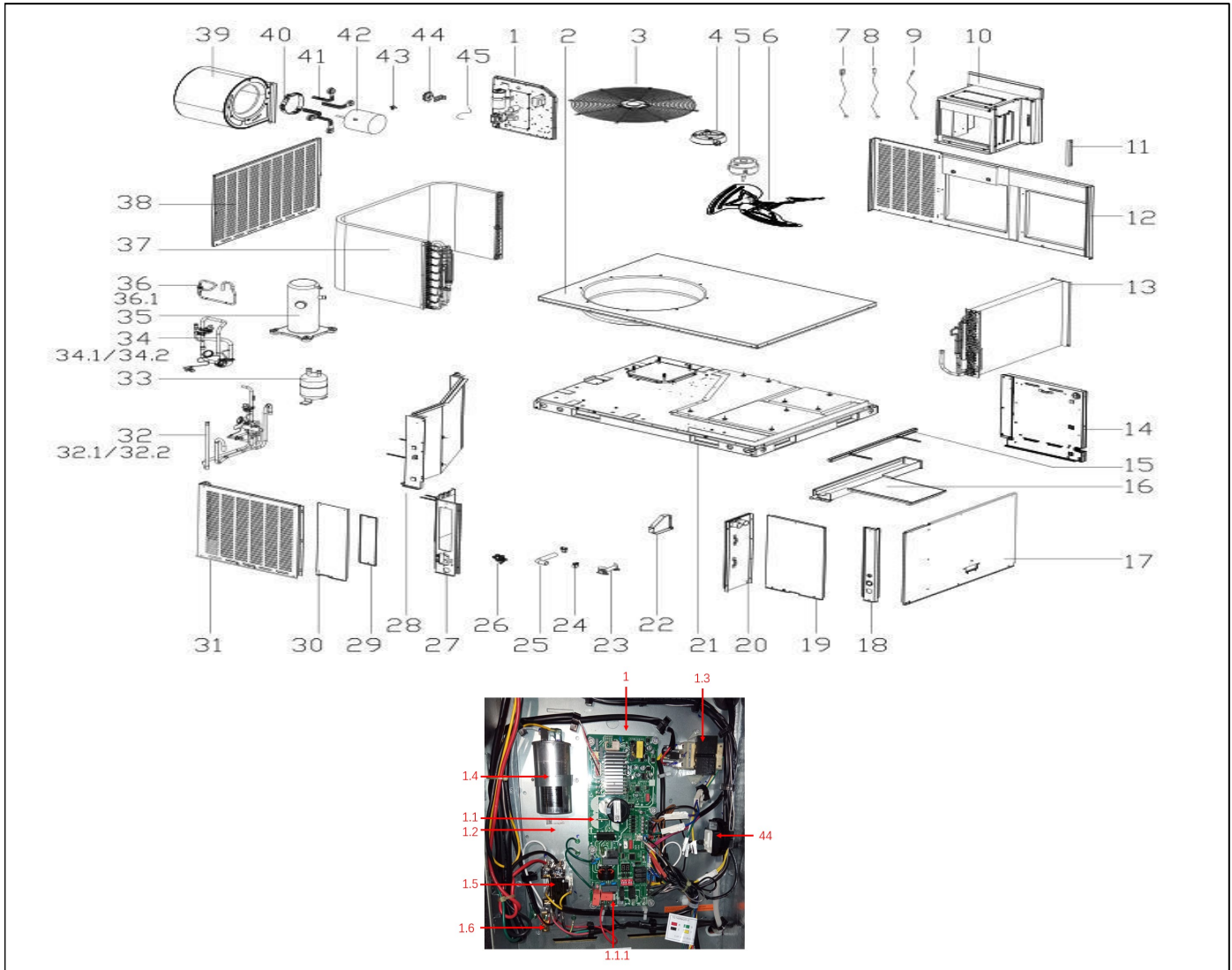

EX_ID	Spare Parts Code	Part Name(EN)	Qty.	Price	Remarks
1	17227700001505	E-part box assembly	1.0		
1.1	17127700001429	Main control board assembly	1.0		
1.2	12227700011535	Electrical appliance mounting plate assembly	1.0		

1.3	11203103000194	Linear Transformer	1.0		
1.4	17400103000150	Capacitor	1.0		
1.5	11203502000032	AC contactor	1.0		
1.6	11201708000008	Wiring Terminal	1.0		
2	12227700009066	Top cover assembly	1.0		
3	12923000000028	Top Cover Guard	1.0		
4	12123000000464	Motor installation board ass'y	1.0		
5	11002015022562	Brushless DC Motor	1.0		
6	12200104000014	Propeller fan	1.0		
7	17400513008234	Discharge temp sensor	1.0		
8	11201007000277	Pipe Temperature Sensor	1.0		T3
9	11201007009384	Room Temperature Sensor	1.0		T4
10	12227700011526	Air duct ass'y	1.0		
11	12227700009070	Fixing board	1.0		
12	12227700009080	Internal panel assembly	1.0		
13	15827700001230	Evaporator ass'y	1.0		
14	12227700011533	Evaporator connecting plate assembly	1.0		
15	12227700004084	Beam assembly	1.0		
16	12227700004072	Drainage pan assembly	1.0		
17	12227700010429	Internal panel assembly	1.0		
18	12227700009074	Column assembly	1.0		
19	12227700A09342	Electric control box cover assembly	1.0		
20	12227700011525	Middle separating plate assembly	1.0		
21	12227700010200	Chassis part	1.0		
22	12227700011534	Preventer plate	1.0		
23	12127700000019	Drainage pipe	1.0		
24	12200201000001	Throat bander	2.0		
25	12627700000036	Connecting pipe ass'y	1.0		
26	12100303000036	Temp. sensor clamp	1.0		
27	12227700009071	Column assembly	1.0		
28	12227700009083	Middle separating plate assembly	1.0		
29	12227700004066	Cover	1.0		
30	12227700A07773	Cover	1.0		
31	12227700009087	Preventer plate	1.0		

32	15427700002495	Four-way valve assembly	1.0		
32.1	15500216003023	Four-way valve kit	1.0		
32.2	17400516001508	High Pressure Controller	1.0		
33	15500508000080	Accumulator cylinder	1.0		
34	15427700002498	Suction pipe assembly	1.0		
34.1	17400516001509	Low Pressure Controller	1.0		
34.2	15427000007112	Fusible plug assembly	1.0		
35	11102010002239	Compressor	1.0		
36	15427700002491	Throttle assembly	1.0		
36.1	15500210004993	Two-Way Throttle Valve	1.0		
37	15827700001388	Condenser ass'y	1.0		
38	12227700004064	Preventer plate	1.0		
39	12200101000473	Centrifugal fan	1.0		
40	12223000001993	Motor bracket II	1.0		
41	12223000001932	Supporter subassembly of fan motor	4.0		
42	11002015022561	Brushless DC Motor	1.0		
43	12127700000297	Sealing Cover	1.0		
44	17400515001120	Air Differential Pressure Switch	1.0		
45	12627600000005	Silicone Tube	1.0		