

# Exploded View

# ComfortStar®

**Model** CPH7-60-15 (30R)  
**Service code:** 30R

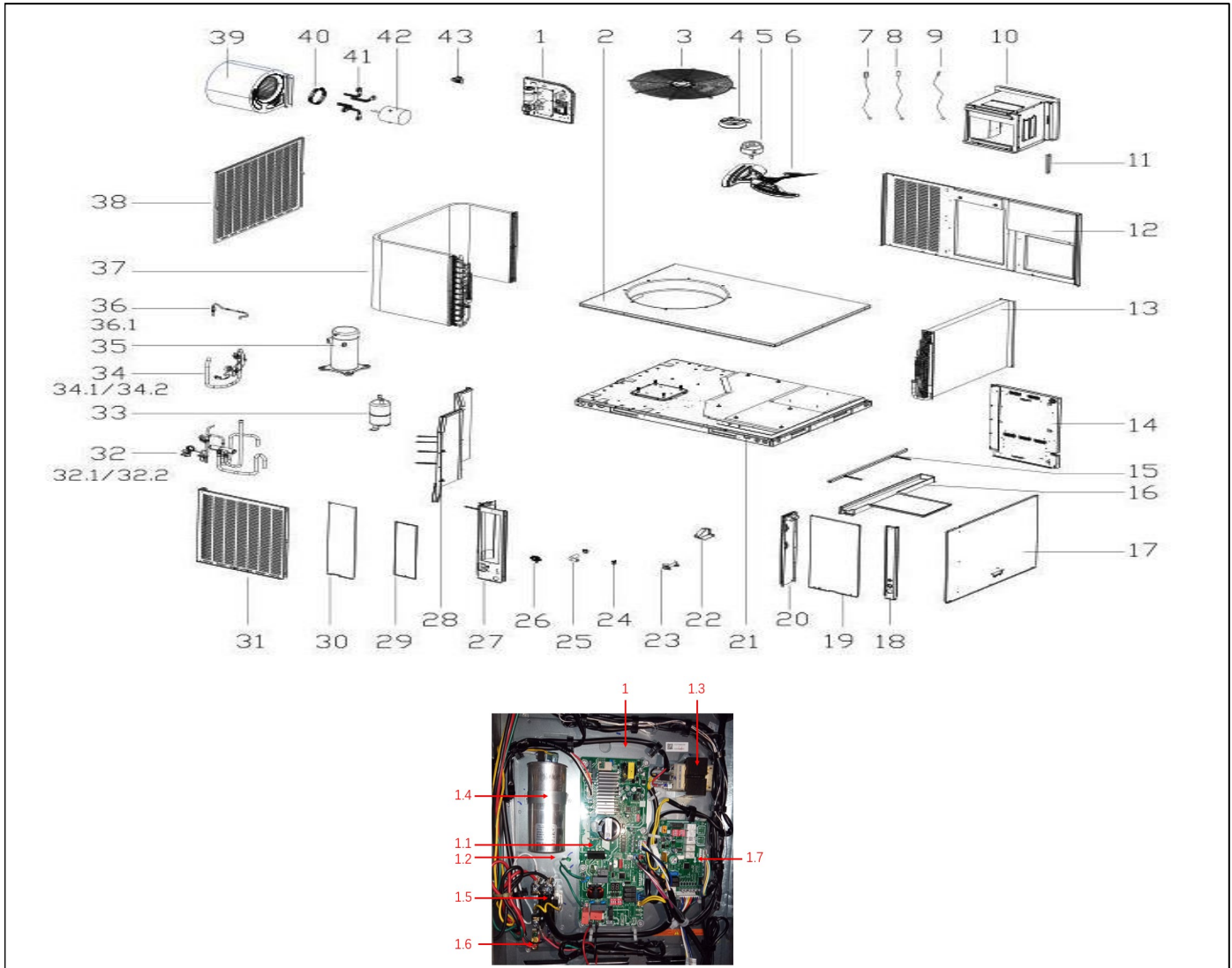

EX_ID	Spare Parts Code	Part Name(EN)	Qty.	Price	Remarks
1	17227700001504	E-part box assembly	1.0		
1.1	17127700001427	Main control board assembly	1.0		
1.2	12227700011535	Electrical appliance mounting plate assembly	1.0		

1.3	11203103000194	Linear Transformer	1.0		
1.4	17400103000133	Capacitor	1.0		
1.5	11203502000032	AC contactor	1.0		
1.6	11201708000008	Wiring Terminal	1.0		
1.7	17123000012124	Control Board	1.0		
2	12227700008942	Top cover assembly	1.0		
3	12927700000085	Top Cover Guard	1.0		
4	12123000000464	Motor installation board ass'y	1.0		
5	11002015022562	Brushless DC Motor	1.0		
6	12200104000038	Propeller fan	1.0		
7	17400513008234	Discharge temp sensor	1.0		
8	11201007000277	Pipe Temperature Sensor	1.0		T3
9	11201007009384	Room Temperature Sensor	1.0		T4
10	12227700011530	Air duct ass'y	1.0		
11	12227700009070	Fixing board	1.0		
12	12227700009068	Internal panel assembly	1.0		
13	15827700001233	Evaporator ass'y	1.0		
14	12227700011532	Evaporator connecting plate assembly	1.0		
15	12227700003996	Beam assembly	1.0		
16	12227700003979	Drainage pan assembly	1.0		
17	12227700010424	Internal panel assembly	1.0		
18	12227700009072	Column assembly	1.0		
19	12227700A09341	Electric control box cover assembly	1.0		
20	12227700011529	Middle separating plate assembly	1.0		
21	12227700A09340	Chassis part	1.0		
22	12227700011531	Preventer plate	1.0		
23	12127700000019	Drainage pipe	1.0		
24	12200201000001	Throat bander	2.0		
25	12627700000016	Connecting pipe ass'y	1.0		
26	12100303000036	Temp. sensor clamp	1.0		
27	12227700009076	Column assembly	1.0		
28	12227700009084	Middle separating plate assembly	1.0		
29	12227700003973	Cover	1.0		
30	12227700A07764	Cover	1.0		

31	12227700009082	Preventer plate	1.0		
32	15427700002505	Four-way valve assembly	1.0		
32.1	15500216003024	Four-way valve kit	1.0		
32.2	17400516001508	High Pressure Controller	1.0		
33	15500508001115	Accumulator cylinder	1.0		
34	15427700002503	Suction pipe assembly	1.0		
34.1	17400516001509	Low Pressure Controller	1.0		
34.2	15427000007112	Fusible plug assembly	1.0		
35	11102010002238	Compressor	1.0		
36	15427700002492	Throttle assembly	1.0		
36.1	15500210004991	Two-Way Throttle Valve	1.0		
37	15827700001248	Condenser ass'y	1.0		
38	12227700003971	Preventer plate	1.0		
39	12200101000053	Centrifugal fan	1.0		
40	12223000001993	Motor bracket II	1.0		
41	12223000001932	Supporter subassembly of fan motor	4.0		
42	11002015022559	Brushless DC Motor	1.0		
43	11201003000424	Gas sensor	1.0		